



VELOCI
PERFORMANCE
PRODUCTS

P 952.746.4825 | 866.686.4020

F 952.746.4829 | 866.686.4021

E orders@velociperformance.com

www.velociperformance.com

V | P | P



VELOCI
PERFORMANCE PRODUCTS™



PRESSURE
WASHING



PORTABLE
HEATING



ENGINE
PARTS



PUMP
KITS

3rd Edition



TABLE OF CONTENTS

06 PRESSURE WASHING

- 07 Spray Guns
Standard, Weep, Free Flow, Extended and Spray Gun Kits
- 11 Lances
Non-Molded, Molded, Dual, Telescoping, Flex, Bendable and Accessories
- 15 Hoses and Hose Reels
Black, Blue, Grey, 4,000PSI, 6,000PSI, Jumper, Sewer, Pulse, Bulk and Consumer
- 18 Thermostats and Switches
Pressure, Vacuum, Remote and Sheaths
- 19 Nozzles and Brooms
QC, Threaded, Packs, Sewer, Soap, Protectors, Hyperjet, Hi-Lo and Turbo and Water Brooms
- 27 Foam Cannons
Adjustable, Professional and Replacements
- 30 Sandblast Kits
Professional, Industrial and Replacements
- 31 Unloaders/Valves
MG4000, BP, Relief, Thermal, Chemical, Ball, Mounting Blocks, Chemical Injectors and Float
- 34 Filters
High-Pressure, Chemical, Water and Fuel
- 35 Fittings
Garden, Twist Seal, Screw Adapters, Couplers and Plugs
- 37 Swivels
AG, Coupling and 90°
- 38 Miscellaneous
Brushes, O-Rings, Pressure Gauges, Tape, Thread Lock, Dampeners, Grommet and Rubber Feet
- 40 Tires
Tube Type and Foam

42 PORTABLE HEATERS

- 43 Radiant
- 45 Indirect
- 47 Accessories
- 48 BTU/h Requirements Chart

50 ENGINE PARTS

58 PUMP KITS

NEW ITEMS

- 07 SGS28 Spray Gun and Magnum 28 Kit
- 08 SG Spray Guns, SG Kits
- 09 M407 Kits
- 10 Inline Spray Gun and Additional Kits
- 16 Upgraded Hoses
- 25 Upgraded Turbo Nozzles
- 29 Snub Gun Foam Kit, Featherweight Foam Cannon and Foam Cannon Replacements
- 33 Ball Valves with Installed Fittings
- 35 Stainless Steel Garden Hose Fittings
- 36 Stainless Steel Locking Couplers and Pivoting Nozzle Holder
- 38 Pressure Gauges
- 51 **Engine Parts**
- 59 **Pump Kits**

WARRANTY

- 05 Pressure Washing
- 41 Heater
- 49 Engine Parts
- 57 Pump Kits

MOVING WORK FORWARD

The equipment you use makes a statement about your business. When you partner with Veloci Performance™ Products — exclusive North American supplier of MTM Hydro products — you're saying that you won't settle for second best. That you care enough about your customers to get the job done right: better, smarter and faster. Move your business ahead with equipment you can stand behind. Count on Veloci Performance™ Products for:

- 1 ASSURED PRODUCT INTEGRITY**
Italian-engineered high-pressure washing, vehicle cleaning and portable heating products and accessories, manufactured to the highest standard to deliver consistently superior results.
- 2 RELIABLE SUPPLY**
Strategically located warehouses for servicing North American markets with on-spec, on-time delivery and accurate invoicing and paperwork.
- 3 RESPONSIVE SERVICE**
A customer-first culture with dedicated account support to help you resolve issues quickly, optimize product usage and make better business decisions.



OUR
**PERFECT
ORDER
PROMISE**
ENSURES
ACCURACY

You can take confidence knowing that, with every product order, we promise:

- ▶ Full quantities, no shortages
- ▶ Products with the right specifications and zero damage
- ▶ On-time delivery to the right location
- ▶ Accurate invoicing and paperwork

ORDER TODAY!

P 952.746.4825 | 866.686.4020
F 952.746.4829 | 866.686.4021
E orders@velociperformance.com

Visit [velociperformance.com](https://www.velociperformance.com)
to view our latest products.

PRESSURE WASHING & PUMP PARTS TERMS AND CONDITIONS

Terms and Conditions of Sales Order / Confirmation ("Agreement")

- 1. Payment.** Standard terms are net 30 days from date of invoice for accounts with approved credit by VELOCI PERFORMANCETM PRODUCTS ("VELOCI"). A service charge of 1.5% per month may be assessed on invoiced over 30 days.
- 2. Shipping.** All freight is shipped freight collect. All other orders are shipped by United Parcel Service (UPS) unless otherwise specified. UPS charges are prepaid and added to the invoice. All shipping discrepancies must be submitted within 24 hours of receipt of products.
- 3. Pricing.** Veloci Performance Products reserves the right to change discounts and/or prices without notice. Trade discounts are based upon unit and dollar volume and are inclusive of warranty allowance. A surcharge may be added to individual orders in response to foreign currency exchange rate fluctuations. Pricing details include: (a) Price list effective January 1, 2018 - Subject to change without notice; (b) All prices F.O.B. Savage, Minnesota; (c) The price in effect at time of shipment will apply; and (d) Pricing discrepancies must be filed within 30 days of invoice
- 4. Minimum Order.** \$30.01 minimum required for all orders. A \$3.50 minimum order fee may be applied to orders below \$30.01.
- 5. Returns.** Returns must follow the following procedures: (a) Returns for credit must be received within 30 days of shipment and pre-approved by Veloci; (b) All returns must be sent freight paid; (c) A return authorization number and invoice copy must accompany all returns; and (d) Please note that a restocking charge may be assessed.
- 6. LIMITED WARRANTY: VELOCI WARRANTS TO THE ORIGINAL PURCHASER OF ITS PRODUCTS ("PURCHASER") THAT SUCH PRODUCTS WILL BE FREE FROM MATERIAL AND WORKMANSHIP DEFECTS UNDER NORMAL USE FOR THE PERIOD OF NINETY (90) DAYS FOR ALL PRODUCTS. "NORMAL USE" DOES NOT INCLUDE USE IN EXCESS OF RECOMMENDED MAXIMUM SPEEDS, FLOWS, PRESSURES, VACUUMS AND TEMPERATURES, OR USE REQUIRING HANDLING OF FLUIDS NOT COMPATIBLE WITH COMPONENT MATERIALS AS NOTED IN THE VELOCI CATALOG, TECHNICAL LITERATURE, AND INSTRUCTIONS. THIS WARRANTY DOES NOT COVER FREIGHT DAMAGE, FREEZING DAMAGE, NORMAL WEAR AND TEAR, OR DAMAGE CAUSED BY MISAPPLICATION, FAULT, NEGLIGENCE, ALTERATIONS, OR REPAIR THAT AFFECTS THE PERFORMANCE OR RELIABILITY OF THE PRODUCT.**
- 7. DISCLAIMER: EXCEPT FOR THE WARRANTY SET FORTH ABOVE, VELOCI MAKES NO WARRANTY WHATSOEVER WITH RESPECT TO THE PRODUCT, INCLUDING ANY WARRANTY OF MERCHANTABILITY OR WARRANTY OF FITNESS FOR A PARTICULAR PURPOSE; WHETHER EXPRESS OR IMPLIED BY LAW, COURSE OF DEALING, COURSE OF PERFORMANCE, USAGE OF TRADE OR OTHERWISE.**
- 8. EXCLUSIVE REMEDY: PURCHASER'S SOLE AND EXCLUSIVE REMEDY AND VELOCI'S ENTIRE LIABILITY FOR ANY BREACH OF THE LIMITED WARRANTY SET FORTH ABOVE SHALL BE TO REPAIR OR REPLACE SUCH DEFECTIVE PRODUCT. ANY DEFECTIVE PRODUCT MUST BE RETURNED TO VELOCI IN ACCORDANCE WITH THE PROCEDURES SET FORTH UNDER "RETURNS".**
- 9. LIMITATION OF LIABILITY: IN NO EVENT SHALL VELOCI BE LIABLE FOR ANY CONSEQUENTIAL, INDIRECT, INCIDENTAL, SPECIAL, EXEMPLARY, PUNITIVE, OR ENHANCED DAMAGES, LOST PROFITS OR REVENUES OR DIMINUTION IN VALUE, ARISING OUT OF, OR RELATING TO, AND/OR IN CONNECTION WITH ANY BREACH OF THIS AGREEMENT, REGARDLESS OF (A) WHETHER SUCH DAMAGES WERE FORESEEABLE, (B) WHETHER OR NOT VELOCI WAS ADVISED OF THE POSSIBILITY OF SUCH DAMAGES, (C) THE LEGAL OR EQUITABLE THEORY (CONTRACT, TORT OR OTHERWISE) UPON WHICH THE CLAIM IS BASED, AND (D) THE FAILURE OF ANY AGREED OR OTHER REMEDY OF ITS ESSENTIAL PURPOSE. FOR THE PURPOSE OF THIS SECTION "CONSEQUENTIAL DAMAGE" SHALL INCLUDE, BUT NOT BE LIMITED TO, LOSS AND/OR DEFERRAL OF PRODUCTION, LOSS OF PRODUCT, LOSS OF USE, LOSS OF REVENUE, PROFIT OR ANTICIPATED PROFIT, LOSS OF CONTRACT AND/OR BUSINESS OPPORTUNITY. IN NO EVENT SHALL VELOCI'S AGGREGATE LIABILITY ARISING OUT OF OR RELATED TO THIS AGREEMENT, WHETHER ARISING OUT OF OR RELATED TO BREACH OF CONTRACT, TORT (INCLUDING NEGLIGENCE) OR OTHERWISE, EXCEED THE TOTAL OF THE AMOUNTS PAID TO VELOCI FOR THE PRODUCT SOLD HEREUNDER.**
- 10. Indemnification.** Purchaser shall indemnify, defend and hold harmless VELOCI and its officers, directors, employees, agents, affiliates, successors and permitted assigns (collectively, "Indemnified Party") against any and all losses, damages, liabilities, deficiencies, claims, actions, judgments, settlements, interest, awards, penalties, fines, costs, or expenses of whatever kind, including reasonable attorneys' fees, fees and the costs of enforcing any right to indemnification under this Agreement and the cost of pursuing any insurance providers, incurred by Indemnified Party, relating to/arising out of or resulting from any claim of a third party or VELOCI arising out of or occurring in connection with the products sold pursuant to this Agreement or Purchaser's negligence, willful misconduct or breach of this Agreement. Purchaser shall not enter into any settlement without VELOCI's or Indemnified Party's prior written consent.
- 11. Choice of Law/Forum.** This Agreement and all matters arising out of or relating to this Agreement, are governed by, and construed and enforced in accordance with, the laws of the State of Minnesota, without regard to the conflict of interest laws provisions. Each party irrevocably and unconditionally agrees that it will not commence any action, litigation, or proceeding of any kind whatsoever against any other party in any way arising from or relating to this Agreement and all contemplated transactions, including, but not limited to, contract, equity, tort, fraud, and statutory claims, in any forum other than the competent courts in the State of Minnesota.



PRESSURE WASHING

Get thorough, first-time cleaning results with high-performance MTM Hydro parts and accessories. Italian-engineered, built to last and shipped fast, our pressure washing equipment keeps projects on schedule and profits on track.

MTM Hydro's Italian SG Spray gun Series



No more fighting with your hose to keep it from slamming into your car. The all new SGS28 Spray Gun boasts a best-in-class Stainless Steel Swivel built into the assembly. No more searching for additional fittings or swivels to purchase or lugging extra steel around.

Cleaning has never been easier with our "Easy Hold" technology. This Italian made gun is manufactured with shockproof reinforced plastic ribbing throughout the entire body of the gun, supporting the pipe and protecting your hand. This gun is rated up to 4,060 PSI, 12 GPM, 320° F.

SGS28 Spray Gun

Part No.	Type	Type Details (Inlet x Outlet)	Each
10.5000	SGS28	3/8" Swivel x 1/4" NPTF	\$139.50



The success of MTM Hydro's SG spray gun series is attributed to the tried and true "Easy Hold" technology. This anti-fatigue ultra-high quality spray gun allows you to clean faster and longer with its broad range of specifications and reliable performance. These guns are rated from 4,000PSI to 5,000 PSI, 8 GPM to 12 GPM, and up to 320° F

MTM Hydro Foam Cannons: The Industry Standard in Cleaning

Magnum 28 Foam Kit

If it drives, flies, or floats..foam it! With the all new MTM Hydro Magnum 28 Gun and Foam Kit, getting dirty never looked this good! Elimnate the risk of swirl marks when you apply thick foam onto your vehicle, truck, boat, house, or restaurant grill and hood. This kit includes the brand new Stainless Steel SGS28 Easy Hold Spray Gun with built-in stainless steel swivel, PF22 Foam Cannon, stainless steel fittings, and a roll of Teflon Tape. The Magnum 28 Foam Kit is rated at 1,100 to 4,000 PSI, 1.8 to 5.3 GPM, and 140 F°

Magnum Foam Kit

Part No.	Size	Product Details (Inlet x Outlet)	Each
14.5008	1.25 mm	1/4" Plug, M22, Tube, & Bottle	\$299.00



SG Spray Guns

Part No.	Type	Type Details (Inlet x Outlet)	Max PSI	Max GPM	Max F°	Each
10.0632	SG28	3/8" NPTF x 1/4" NPTF	4,000	12	320°F	\$65.30
10.0633	SG28 Acid	3/8" NPTF x 1/4" NPTF	4,000	12	320°F	\$70.00
10.0608	SG31 Weep	3/8" BSPF x 1/4" BSPF	4,500	8	320°F	\$101.60
10.0342	SG35	3/8" NPTF x 1/4" NPTF	5,000	12	320°F	\$76.10
10.0381	SG35 Acid	3/8" NPTF x 1/4" NPTF	5,000	12	320°F	\$84.20
10.0440	SG35 Kew	3/8" BSPF Swivel x KC35 Kew Coupling	4,500	12	320°F	\$191.80
10.0346	SG40	3/8" NPTF x 1/4" NPTF	5,800	8	320°F	\$84.20

Kew Fittings

Part No.	Type	Type Details (Inlet x Outlet)	Max PSI	Max GPM	Max F°	Each
24.0025	Stainless Steel	Kew Style Inlet Plug	--	--	--	\$46.90
24.0619	Kew Coupler	Kew Style Spray Gun Outlet 1/4M (Push Open)	4,500	--	--	\$106.00
24.0620	Kew Coupler	Kew Style Spray Gun Outlet 1/4M (Pull Open)	4,500	--	--	\$106.00

SG Spray Gun Assemblies

Part No.	Packaging	Type Details (Inlet x Outlet)	Max PSI	Max GPM	Max F°	Each
43.0002	Bulk	SG35 Spray Gun, & Dual Lance w/ Chem. Nozzle & QC	4,100	10.5	300°F	\$190.00
43.0024	Individual	SG35 Spray Gun, 36" Upgraded Lance, & 50' x 3/8" Upgraded Blue Hose	5,000	12	310°F	\$421.00
43.0031	Bulk	SG35 Spray Gun w/ Inlet Plug, & 36" Molded Lance w/ QC	5,000	12	320°F	\$133.50
43.0078	Bulk	SG40 Spray Gun, & 36" Stainless Steel Vented Lance	5,800	8	320°F	\$147.00

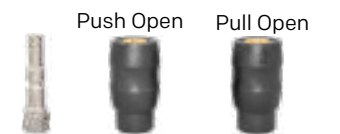



M407 Spray Guns

Part No.	Type	Type Details (Inlet x Outlet)	Max PSI	Max GPM	Max F°	Each
10.0001	M407	3/8" NPTF x 1/4" NPTF	4,000	7	250°F	\$59.75
10.0003	W/ Extension	3/8" NPTF x M22x1.5F	4,000	7	250°F	\$72.25
10.0043	W/ Inlet Plug	3/8" QC Plug x 1/4" NPTF	4,000	7	250°F	\$67.75
41.0002	Repair Kit	Repair Kit Full For M407 Spray Gun	--	--	--	\$16.70

Additional Spray Gun Assemblies

Part No.	Packaging	Type Details (Inlet x Outlet)	Max PSI	Max GPM	Max F°	Each
17.0061	Bulk	Front Entry Extended Spray Gun, PVC Hose, & Lance Extension	3,000	7	140°F	\$142.00
43.5007	Individual	Front Entry Extended Spray Gun, PVC Hose, & Lance Extension	3,000	7	140°F	\$148.50



M407 Spray Gun Assemblies

Part No.	Packaging	Type Details (Inlet x Outlet)	Max PSI	Max GPM	Max F°	Each
14.5005	Individual	M407 Spray Gun, & Foam Cannon	4,000	5.3	140°F	\$183.00
41.0294	Individual	M407 Spray Gun w/ Extension, & 50' x 3/8" Hose & Fittings	4,000	7	250°F	\$291.00
41.0691	Individual	M407 Spray Gun w/ Extension, Nozzles, 50' x 3/8" Hose, Lance, & Fittings	4,000	7	250°F	\$307.00
43.0001	Bulk	M407 Spray Gun, & Dual Lance w/ Chemical Nozzle & QC	4,000	7	250°F	\$138.00
43.0029	Bulk	M407 Spray Gun w/ Inlet Plug, & 36" Molded Lance w/ QC	4,000	7	250°F	\$77.00
43.0055	Bulk	M407 Spray Gun, & 18" Extension Lance, & Male Plug	4,000	7	250°F	\$100.50
43.5000	Bulk	M407 Spray Gun w/ Inlet Plug, & 18" Molded Lance w/ QC	4,000	7	250°F	\$80.00
43.5001	Individual	M407 Spray Gun, 50' Sewer Jetting Hose, & Sewer Jetting Nozzle	4,000	7	160°F	\$317.00
43.5002	Individual	M407 Spray Gun, 100' Sewer Jetting Hose, & Sewer Jetting Nozzle	4,000	7	160°F	\$566.00

InLine Spray Gun

Part No.	Type	Type Details (Inlet x Outlet)	Max PSI	Max GPM	Max F°	Each
10.5004	InLine	3/8" NPTF x 1/4" NPTF	5,000	10	300°F	\$67.25



Front Entry Extended Spray Gun

Part No.	Type	Type Details (Inlet x Outlet)	Max PSI	Max GPM	Max F°	Each
10.0339	Front Entry	M22 M x M22 F	3,000	7	140°F	\$57.00



Astra Spray Guns

Part No.	Type	Type Details (Inlet x Outlet)	Max PSI	Max GPM	Max F°	Each
10.0007	Astra	3/8" BSPF x 1/4" BSPF	5,000	11.5	300°F	\$86.50
10.0032	Free Flow	3/8" BSPF x 1/4" BSPF	5,000	11.5	300°F	\$52.50
41.0096	Repair Kit	Full Repair Kit For Astra Spray Gun	--	--	--	\$36.75



14.5005



41.0691



41.0294



43.5001 & 43.5002



43.0029 & 43.5000



43.0055



Non Molded Stainless Spray Lances

Part No.	Size	Type Details (Inlet x Outlet)	Max PSI	Max GPM	Max F°	Each
28.0267	20"	1/4" NPT x 1/4" NPT	4,100	10.5	300°F	\$18.30
28.0117	24"	1/4" NPT x 1/4" NPT	4,100	10.5	300°F	\$21.40
28.0268	28"	1/4" NPT x 1/4" NPT	4,100	10.5	300°F	\$25.30
28.0118	36"	1/4" NPT x 1/4" NPT	4,100	10.5	300°F	\$29.40
28.0119	48"	1/4" NPT x 1/4" NPT	4,100	10.5	300°F	\$44.80
28.0120	60"	1/4" NPT x 1/4" NPT	4,100	10.5	300°F	\$53.40
28.0272	78"	1/4" NPT x 1/4" NPT	4,100	10.5	300°F	\$67.80

Non Molded Zinc Plated Spray Lances

Part No.	Size	Type Details (Inlet x Outlet)	Max PSI	Max GPM	Max F°	Each
28.0277	12"	1/4" NPT x 1/4" NPT	4,100	10.5	300°F	\$5.40
28.0278	18"	1/4" NPT x 1/4" NPT	4,100	10.5	300°F	\$6.70
28.0279	20"	1/4" NPT x 1/4" NPT	4,100	10.5	300°F	\$7.50
28.0280	24"	1/4" NPT x 1/4" NPT	4,100	10.5	300°F	\$8.80
28.0281	36"	1/4" NPT x 1/4" NPT	4,100	10.5	300°F	\$12.90
28.0282	48"	1/4" NPT x 1/4" NPT	4,100	10.5	300°F	\$15.70
28.0283	60"	1/4" NPT x 1/4" NPT	4,100	10.5	300°F	\$19.30
28.0284	78"	1/4" NPT x 1/4" NPT	4,100	10.5	300°F	\$25.30

Non Molded Aluminum Spray Lances

Part No.	Size	Type Details (Inlet x Outlet)	Max PSI	Max GPM	Max F°	Each
28.0001	12"	1/4" NPT x 1/4" NPT	3,600	10.5	300°F	\$5.70
28.0002	18"	1/4" NPT x 1/4" NPT	3,600	10.5	300°F	\$8.20
28.0003	24"	1/4" NPT x 1/4" NPT	3,600	10.5	300°F	\$11.10
28.0004	36"	1/4" NPT x 1/4" NPT	3,600	10.5	300°F	\$16.00
28.0005	47"	1/4" NPT x 1/4" NPT	3,600	10.5	300°F	\$18.80
28.0006	59"	1/4" NPT x 1/4" NPT	3,600	10.5	300°F	\$22.40
28.0007	79"	1/4" NPT x 1/4" NPT	3,600	10.5	300°F	\$30.40

Non Molded Zinc Extension Lances

Part No.	Size	Type Details (Inlet x Outlet)	Max PSI	Max GPM	Max F°	Each
12.0096	36"	1/4" MPT x Brass QC Coupler	4,100	10.5	300°F	\$30.25
28.0022	18"	M22M x 1/4" QC Coupler	4,100	10.5	300°F	\$20.30
28.0023	24"	M22M x 1/4" QC Coupler	4,100	10.5	300°F	\$22.30

Vented MT2 Spray Lances

Part No.	Size	Type Details (Inlet x Outlet)	Max PSI	Max GPM	Max F°	Each
12.0003	28"	Zinc Plated Steel 1/4" NPTM x 1/4" NPTM	4,100	10.5	300°F	\$33.20
12.0004	36"	Zinc Plated Steel 1/4" NPTM x 1/4" NPTM	4,100	10.5	300°F	\$36.10
12.0005	47"	Zinc Plated Steel 1/4" NPTM x 1/4" NPTM	4,100	10.5	300°F	\$46.40
12.0019	36"	Stainless 1/4" NPTM x 1/4" NPTM	4,100	10.5	300°F	\$58.50
12.0020	47"	Stainless 1/4" NPTM x 1/4" NPTM	4,100	10.5	300°F	\$92.30

Oval Molded MT3 Spray Lances

Part No.	Size	Type Details (Inlet x Outlet)	Max PSI	Max GPM	Max F°	Each
14.0050	28"	Zinc Plated Steel 1/4" NPTM x 1/4" NPTM	4,100	10.5	300°F	\$26.30
14.0051	36"	Zinc Plated Steel 1/4" NPTM x 1/4" NPTM	4,100	10.5	300°F	\$28.10
14.0052	47"	Zinc Plated Steel 1/4" NPTM x 1/4" NPTM	4,100	10.5	300°F	\$36.60
14.0054	79"	Zinc Plated Steel 1/4" NPTM x 1/4" NPTM	4,100	10.5	300°F	\$59.50
14.0055	28"	Stainless 1/4" NPTM x 1/4" NPTM	4,100	10.5	300°F	\$41.80
14.0056	36"	Stainless 1/4" NPTM x 1/4" NPTM	4,100	10.5	300°F	\$45.60
14.0057	47"	Stainless 1/4" NPTM x 1/4" NPTM	4,100	10.5	300°F	\$62.60
14.0058	59"	Stainless 1/4" NPTM x 1/4" NPTM	4,100	10.5	300°F	\$80.90
14.0059	79"	Stainless 1/4" NPTM x 1/4" NPTM	4,100	10.5	300°F	\$101.50

Round Molded Spray Lances

Part No.	Size	Type Details (Inlet x Outlet)	Max PSI	Max GPM	Max F°	Each
12.0463	12"	Plated Steel 1/4" NPTM x 1/4" NPTM	4,100	10.5	300°F	\$10.00
12.0464	18"	Plated Steel 1/4" NPTM x 1/4" NPTM	4,100	10.5	300°F	\$11.00
12.0053	28"	Plated Steel 1/4" NPTM x 1/4" NPTM	4,100	10.5	300°F	\$14.40
12.0054	36"	Plated Steel 1/4" NPTM x 1/4" NPTM	4,100	10.5	300°F	\$18.50
12.0055	47"	Plated Steel 1/4" NPTM x 1/4" NPTM	4,100	10.5	300°F	\$23.60
12.0056	59"	Plated Steel 1/4" NPTM x 1/4" NPTM	4,100	10.5	300°F	\$29.75
12.0057	79"	Plated Steel 1/4" NPTM x 1/4" NPTM	4,100	10.5	300°F	\$35.75

MT8 Vented Grips

Part No.	Size	Type Details (Inlet x Outlet)	Max PSI	Max GPM	Max F°	Each
41.0089	Replacement	MT8 Black Vented Grip w/o Pipe	--	--	--	\$13.90
41.0383	Replacement	MT8 Blue Vented Grip w/o Pipe	--	--	--	\$13.90



Dual MT8 Spray Lances

Part No.	Size	Type Details (Inlet x Outlet)	Max PSI	Max GPM	Max F°	Each
12.0505	42"	1/4" Zinc Plated 1/4" NPTM x 1/4" NPTF	4,100	10.5	300°F	\$99.70
12.0506	42"	1/4" Stainless 1/4" NPTM x 1/4" NPTF	4,100	10.5	300°F	\$137.40
12.0512	42"	1/4" Stainless w/ Chem Nozzle 1/4" NPTM x 1/4" NPTF	4,100	10.5	300°F	\$143.30
12.0513	42"	1/4" Stainless w/ Chem. Nozzle, & QC 1/4" NPTM x 1/4" NPTF	4,100	10.5	300°F	\$154.60
12.0526	42"	1/4" Zinc Plated w/ Chem. Nozzle, & QC 1/4" NPTM x 1/4" NPTF	4,100	10.5	300°F	\$105.70



Dual MT5 Spray Lances

Part No.	Size	Type Details (Inlet x Outlet)	Max PSI	Max GPM	Max F°	Each
12.0039	37"	1/8" Zinc Plated Steel 1/4" BSPM x 1/4" BSPF	3,600	10.5	300°F	\$122.00



Dual Spray Lance With Trigger

Part No.	Size	Type Details (Inlet x Outlet)	Max PSI	Max GPM	Max F°	Each
12.0591	47"	1/8" Stainless 1/4" BSPM x 1/4" BSPF	3,600	10.5	300°F	\$175.00



Dual Lance Replacements

Part No.	Type	Type Details (Inlet x Outlet)	Max PSI	Max GPM	Max F°	Each
12.0001	Side Handle	Side Handle w/ Brass Nut	--	--	--	\$10.25
24.0060	Nut	Open C Hook For Side Handle	--	--	--	\$1.30
41.0033	Repair Kit	Dual Lance Repair Kit w/ Trigger	--	--	--	\$20.80
41.5000	Full Repair Kit	MT8 Dual Lance Full Repair Kit w/ Handle	--	--	--	\$20.50

Deluxe TL28 Lance

Part No.	Size	Type Details (Inlet x Outlet)	Max PSI	Max GPM	Max F°	Each
27.0080	18'	Telescoping Wand w/ Support Belt Kit	4,100	--	250°F	\$370.00
27.0082	24'	Telescoping Wand w/ Support Belt Kit	4,100	--	250°F	\$462.00
24.0500	Ring Nut	M22 x 1.5"F	--	--	--	\$25.25
27.0083	Replacement	Telescoping Lance Suppor Belt Kit	--	--	--	\$48.00
27.0089	Replacement	Non Molded Telescoping Lance Extension	--	--	--	\$18.20
30.0159	Replacement	5/16" Replacement Hose For 18' Lance	--	--	--	\$131.50
30.0160	Replacement	5/16" Replacement Hose For 24' Lance	--	--	--	\$131.50
41.0385	Replacement	Telescoping Lance Gun Assembly	--	--	--	\$137.00
41.0609	Replacement	Large & Small Pole Pin Lock Snap Collars	--	--	--	\$17.20



Gutter Cleaning Attachments

Part No.	Size	Type Details (Inlet x Outlet)	Max PSI	Max GPM	Max F°	Each
22.0110	--	1/4" QC Plug x 1/4" QC Coupler	--	--	--	\$16.40
22.0334	28"	1/4" MPT x 1/4" QC Coupler	--	--	--	\$28.75
22.0339	28"	1/4" QC Plated Steel Plug x 1/4" QC Brass Coupler	--	--	--	\$43.00
22.0340	28"	M22 Brass Plug x 1/4" QC Brass Coupler	--	--	--	\$43.00



Insulated Car Wash Lance

Part No.	Size	Type Details (Inlet x Outlet)	Max PSI	Max GPM	Max F°	Each
12.0050	36"	Stainless 1/4" NPTM x 1/4" NPTF	4,100	10.5	300°F	\$73.25



Car Wash Lance

Part No.	Size	Type Details (Inlet x Outlet)	Max PSI	Max GPM	Max F°	Each
30.0225	16"	1/4" NPTM x 1/4" NPTM w/ Coil Spring Guard	3,000	--	90°F	\$53.75
30.0226	16"	1/4" NPTM x 1/4" NPTM w/ Coil Spring Gaurd & Nozzle Protector	3,000	--	90°F	\$56.50



Bendable Car Wash Lance

Part No.	Size	Type Details (Inlet x Outlet)	Max PSI	Max GPM	Max F°	Each
12.0059	18"	Zinc Plated 1/4" NPTM x 1/4" NPTM	2,500	8	195°F	\$27.75
12.0061	18"	Stainless 1/4" NPTM x 1/4" NPTM	2,500	8	195°F	\$44.00



Combine "Hose Fitting Upgrade" part number with any of the below hose part numbers.
 Example:
 Qty. 1 - 30.0048
 Qty. 1 - 24.0186

Hose Fitting Upgrades

Part No.	Type	Type Details (Inlet x Outlet)	Max PSI	Max GPM	Max F°	Each
24.0186	Installed Fitting	3/8" Brass QC Coupler & Plated Steel Plug	--	--	--	\$14.10
24.0189	Installed Fitting	3/8" Stainless QC Coupler & Plug	--	--	--	\$23.90
24.0192	Installed Fitting	3/8" M22 F Coupler (Both Ends)	--	--	--	\$18.50

Black Kobrajel Hose

Part No.	Size	Type Details (Inlet x Outlet)	Max PSI	Max GPM	Max F°	Each
30.0048	25'	3/8" NPTM - 1 Wire	4,000	--	-40 - 275	\$89.40
30.0049	50'	3/8" NPTM - 1 Wire	4,000	--	-40 - 275	\$156.70
30.0050	75'	3/8" NPTM - 1 Wire	4,000	--	-40 - 275	\$222.70
30.0051	100'	3/8" NPTM - 1 Wire	4,000	--	-40 - 275	\$290.70
30.0052	25'	3/8" NPTM - 2 Wire	6,000	--	-40 - 275	\$115.50
30.0053	50'	3/8" NPTM - 2 Wire	6,000	--	-40 - 275	\$199.50
30.0054	75'	3/8" NPTM - 2 Wire	6,000	--	-40 - 275	\$282.50
30.0055	100'	3/8" NPTM - 2 Wire	6,000	--	-40 - 275	\$368.00

Non Marking Blue Kobrajel Hose

Part No.	Size	Type Details (Inlet x Outlet)	Max PSI	Max GPM	Max F°	Each
29.0009	25'	3/8" NPTM - 1 Wire	4,000	--	-40 - 275	\$96.10
29.0010	50'	3/8" NPTM - 1 Wire	4,000	--	-40 - 275	\$178.40
29.0011	75'	3/8" NPTM - 1 Wire	4,000	--	-40 - 275	\$237.60
29.0012	100'	3/8" NPTM - 1 Wire	4,000	--	-40 - 275	\$329.90
29.0014	25'	3/8" NPTM - 2 Wire	6,000	--	-40 - 275	\$117.50
29.0015	50'	3/8" NPTM - 2 Wire	6,000	--	-40 - 275	\$206.20
29.0016	75'	3/8" NPTM - 2 Wire	6,000	--	-40 - 275	\$292.80
29.0017	100'	3/8" NPTM - 2 Wire	6,000	--	-40 - 275	\$377.30

Non Marking Grey Kobrajel Hose

Part No.	Size	Type Details (Inlet x Outlet)	Max PSI	Max GPM	Max F°	Each
29.0110	50'	3/8" NPTM - 1 Wire	4,000	--	-40 - 275	\$178.40
29.0111	100'	3/8" NPTM - 1 Wire	4,000	--	-40 - 275	\$329.90

Hose Reels

Part No.	Size	Product Details (Inlet x Outlet)	Max PSI	Max GPM	Max F°	Each
27.0006	50'	3/8" NPTM x 3/8" NPTF - 12.5" x 11.5"	4,000	--	140°	\$159.50
27.0004	100'	3/8" NPTM x 3/8" NPTF - 12.5" x 15.5"	4,000	--	140°	\$199.50
27.0005	150'	3/8" NPTM x 3/8" NPTF - 16.5" x 15.5"	4,000	--	140°	\$244.50
27.0007	200'	3/8" NPTM x 3/8" NPTF - 16.5" x 21"	4,000	--	140°	\$285.00
39.0048	Replacement	Swivel O-Ring	--	--	--	\$1.25
41.0086	Replacement	Universal Hose Reel Handle Kit	--	--	--	\$13.30
41.0087	Replacement	50' & 100' Hose Reel Swivel 1/2" NPTM x 3/8" NPTF	--	--	--	\$46.75
41.0088	Replacement	150' & 200' Hose Reel Swivel 3/4" NPTM x 3/8" NPTF	--	--	--	\$53.00

Upgraded Black Kobrajel Hose

Part No.	Size	Type Details (Inlet x Outlet)	Max PSI	Max GPM	Max F°	Each
30.0169	50'	3/8" 1 Wire Hose w/ 3/8" Socket & 3/8" Plug Installed	4,000	--	-40 - 275	\$169.00
30.0252	100'	3/8" 1 Wire Hose w/ 3/8" Socket & 3/8" Plug Installed	4,000	--	-40 - 275	\$303.00

Upgraded Non Marking Blue Kobrajel Hose

Part No.	Size	Type Details (Inlet x Outlet)	Max PSI	Max GPM	Max F°	Each
29.0122	50'	3/8" 1 Wire Hose w/ 3/8" Socket & 3/8" Plug Installed	4,000	--	-40 - 275	\$191.80
29.0124	100'	3/8" 1 Wire Hose w/ 3/8" Socket & 3/8" Plug Installed	4,000	--	-40 - 275	\$343.30

Upgraded Non Marking Grey Kobrajel Hose

Part No.	Size	Type Details (Inlet x Outlet)	Max PSI	Max GPM	Max F°	Each
29.0129	50'	3/8" 1 Wire Hose w/ 3/8" Socket & 3/8" Plug Installed	4,000	--	-40 - 275	\$191.80
29.0130	100'	3/8" 1 Wire Hose w/ 3/8" Socket & 3/8" Plug Installed	4,000	--	-40 - 275	\$343.30

Hose Parts

Part No.	Type	Type Details (Inlet x Outlet)	Max PSI	Max GPM	Max F°	Each
40.0025	Bulk Hose	3/8" Black Hose (Sold per ft.)	4,000	--	-40 - 275	\$3.60
40.0026	Bulk Hose	3/8" Non Marking Blue Hose (Sold per ft.)	4,000	--	-40 - 275	\$3.90
40.0027	Bulk Hose	3/8" Black Hose (Sold per ft.)	6,000	--	-40 - 275	\$4.60
40.0028	Bulk Hose	3/8" Non Marking Blue Hose (Sold per ft.)	6,000	--	-40 - 275	\$5.20
24.0158	Hose End	3/8" M Rigid Hose End	--	--	--	\$7.95
24.0160	Hose End	3/8" M Swivel Hose End	--	--	--	\$11.80
39.0377	Bend Restrictor	6" Black Bend Restrictor For Use With 4,000 Max PSI Hose	--	--	--	\$3.75
39.0425	Bend Restrictor	6" Red Bend Restrictor For Use With 6,000 Max PSI Hose	--	--	--	\$4.50
24.0462	Hose End	3/8" Hose End Ferrule	4,000 6,000	--	--	\$6.15



Components are sold individually, Veloci Performance Products does not produce custom hose assemblies.





High Pressure Consumer Hose

Part No.	Size	Type Details (Inlet x Outlet)	Max PSI	Max GPM	Max F°	Each
30.0130	25'	1/4" PVC Hose w/ M22F - 14mm Ends	3,200	--	--	\$58.50



Sewer Jetting Hose

Part No.	Size	Type Details (Inlet x Outlet)	Max PSI	Max GPM	Max F°	Each
16.0229	50'	1/8" Hose 1/8" NPTM x 1/8" NPTM	4,000	--	160°F	\$190.00
16.0230	100'	1/8" Hose 1/8" NPTM x 1/8" NPTM	4,000	--	160°F	\$379.00
16.0231	50'	1/4" Hose 1/4" NPTM x 1/4" NPTM	4,000	--	160°F	\$237.00
16.0232	100'	1/4" Hose 1/4" NPTM x 1/4" NPTM	4,000	--	160°F	\$453.00

3/8" Jumper Hose

Part No.	Size	Type Details (Inlet x Outlet)	Max PSI	Max GPM	Max F°	Each
30.0026	2'	3/8" NPTM Rigid x 3/8" NPTM Swivel	4,000	--	-40 - 275	\$37.00
30.0027	3'	3/8" NPTM Rigid x 3/8" NPTM Swivel	4,000	--	-40 - 275	\$39.75
30.0028	4'	3/8" NPTM Rigid x 3/8" NPTM Swivel	4,000	--	-40 - 275	\$42.50
30.0029	5'	3/8" NPTM Rigid x 3/8" NPTM Swivel	4,000	--	-40 - 275	\$45.75
30.0030	6'	3/8" NPTM Rigid x 3/8" NPTM Swivel	4,000	--	-40 - 275	\$48.50
30.0031	8'	3/8" NPTM Rigid x 3/8" NPTM Swivel	4,000	--	-40 - 275	\$54.50
30.0032	10'	3/8" NPTM Rigid x 3/8" NPTM Swivel	4,000	--	-40 - 275	\$58.50
30.0034	2'	3/8" NPTM Rigid x 3/8" NPTM Swivel	6,000	--	-40 - 275	\$38.50
30.0035	3'	3/8" NPTM Rigid x 3/8" NPTM Swivel	6,000	--	-40 - 275	\$42.25
30.0036	4'	3/8" NPTM Rigid x 3/8" NPTM Swivel	6,000	--	-40 - 275	\$45.75
30.0037	5'	3/8" NPTM Rigid x 3/8" NPTM Swivel	6,000	--	-40 - 275	\$49.00
30.0038	6'	3/8" NPTM Rigid x 3/8" NPTM Swivel	6,000	--	-40 - 275	\$52.50
30.0039	8'	3/8" NPTM Rigid x 3/8" NPTM Swivel	6,000	--	-40 - 275	\$58.50
30.0040	10'	3/8" NPTM Rigid x 3/8" NPTM Swivel	6,000	--	-40 - 275	\$68.75

Bulk Push Lock Hoses

Part No.	Type	Type Details (Inlet x Outlet)	Max PSI	Max GPM	Max F°	Each
31.0013	Hose	1/4" Insta Grip (Sold per ft.)	250	--	--	\$3.85
31.0014	Hose	3/8" Insta Grip (Sold per ft.)	250	--	--	\$4.90
31.0015	Hose	1/2" Insta Grip (Sold per ft.)	250	--	--	\$5.75
24.0154	Push Lock Fitting	1/4" HB x 1/4" MPT	260	--	--	\$3.60
24.0155	Push Lock Fitting	3/8" HB x 3/8" MPT	260	--	--	\$4.90
24.0156	Push Lock Fitting	1/2" HB x 1/2" MPT	260	--	--	\$7.95
24.0157	Push Lock Fitting	3/8" HB x 1/4" MPT	260	--	--	\$4.35

Pulse Hose Assembly

Part No.	Size	Type Details (Inlet x Outlet)	Max PSI	Max GPM	Max F°	Each
30.0147	12"	3/8" MPT	2,000	--	--	\$32.75

"Big" Pressure Switch

Part No.	Type	Type Details (Inlet x Outlet)	Max PSI	Max GPM	Max F°	Each
21.0016	3 Wires	1/4 NPTM - 250 V - 15 A Pressure On - ● 115 Max PSI	4,100	--	195°F	\$55.70
21.0014	3 Wires	1/4 NPTM - 250 V - 15 A Pressure On - ● 210 Max PSI	4,100	--	195°F	\$55.70
21.0010	3 Wires	1/4 NPTM - 250 V - 15 A Pressure On - ● 360 Max PSI	4,100	--	195°F	\$55.70
21.0011	3 Wires	1/4 NPTM - 250 V - 15 A Pressure On - ● 580 Max PSI	4,100	--	195°F	\$55.70
21.0017	3 Wires	3/8 NPTM - 250 V - 15 A Pressure On - ● 115 Max PSI	4,100	--	195°F	\$55.70
21.0015	3 Wires	3/8 NPTM - 250 V - 15 A Pressure On - ● 210 Max PSI	4,100	--	195°F	\$55.70
21.0012	3 Wires	3/8 NPTM - 250 V - 15 A Pressure On - ● 360 Max PSI	4,100	--	195°F	\$55.70
21.0013	3 Wires	3/8 NPTM - 250 V - 15 A Pressure On - ● 580 Max PSI	4,100	--	195°F	\$55.70
41.0020	Repair Kit	Electrical 3 Wire	--	--	--	\$29.25
41.0095	Replacement	Microswitch "Big"	--	--	--	\$7.70

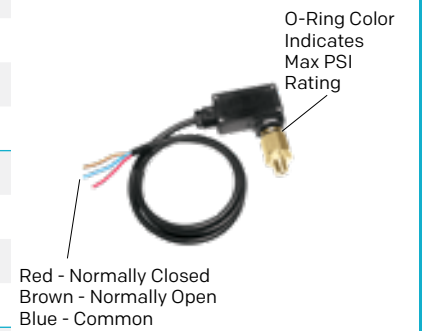

Vacuum Switch

Part No.	Type	Type Details (Inlet x Outlet)	Max PSI	Max GPM	Max F°	Each
21.0018	1.5" Hg	1/4" NPTF - 250 V - 16 A	--	--	131°F	\$46.60
21.0019	2.0" Hg	1/4" NPTF - 250 V - 16 A	--	--	131°F	\$46.60
21.0020	2.5" Hg	1/4" NPTF - 250 V - 16 A	--	--	131°F	\$46.60
21.0021	4.0" Hg	1/4" NPTF - 250 V - 16 A	--	--	131°F	\$46.60
21.0022	4.5" Hg	1/4" NPTF - 250 V - 16 A	--	--	131°F	\$46.60



Remote Thermostat w/ Probe & Adapter Plug

Part No.	Size	Type Details (Inlet x Outlet)	Max PSI	Max GPM	Max F°	Each
21.0023	59"	1/2" NPTM 250 V - 15 A - 7x120mm Probe	4,000	--	195°F	\$89.75
21.0024	72"	1/2" NPTM 250 V - 15 A - 7x120mm Probe	4,000	--	248°F	\$87.00
21.0025	72"	1/2" NPTM 250 V - 15 A - 7x120mm Probe	4,000	--	300°F	\$87.00



Thermostat Well Housing

Part No.	Type	Type Details (Inlet x Outlet)	Max PSI	Max GPM	Max F°	Each
22.0091	1/2" NPTF Connection	Brass 3/8" NPTF x 3/8" NPTF + 3/8" NPTF	4,660	--	320°F	\$51.25



Thermostat Probe Sheath

Part No.	Size	Type Details (Inlet x Outlet)	Max PSI	Max GPM	Max F°	Each
22.0089	4"	Brass 1/2" NPTM - 7mm Hole	4,660	--	320°F	\$24.10



Nozzle Selection Chart

To properly select the correct nozzle for your system from the chart below, select the Max GPM of your machine from the left hand column. Secondly, select the Max PSI of your machine from the top row of the chart. Where the Max GPM row and Max PSI column intersect is the proper size nozzle for your system. (See highlighted cells for reference).

GPM	Max PSI									
	500	1,000	1,500	2,000	3,000	3,500	4,000	4,500	5,000	6,000
2.0	5.5	4.0	3.5	3.0	2.5	2.0	2.0	2.0	2.0	1.5
2.5	7.0	5.0	4.0	3.5	3.0	2.5	2.5	2.5	2.0	2.0
3.0	8.5	6.0	5.0	4.0	3.5	3.0	3.0	3.0	2.5	2.5
3.5	10.0	7.0	5.5	5.0	4.0	3.5	3.5	3.5	3.0	3.0
4.0	12.0	8.0	6.5	5.5	4.5	4.5	4.0	4.0	3.5	3.5
4.5	13.0	9.0	7.5	6.5	5.0	5.0	4.5	4.0	4.0	3.5
5.0	15.0	10.0	8.0	7.0	6.0	5.5	5.0	4.5	4.5	4.0
5.5	20.0	11.0	9.0	8.0	6.5	6.0	5.5	5.0	5.0	4.5
6.0	20.0	12.0	10.0	8.5	7.0	6.5	6.0	5.5	5.5	5.0
6.5	20.0	13.0	11.0	9.0	7.5	7.0	6.5	6.0	6.0	5.5
7.0	20.0	15.0	12.0	10.0	8.0	7.5	7.0	6.5	6.5	5.5
7.5	30.0	15.0	12.0	11.0	8.5	8.0	7.5	7.0	6.5	6.0
8.0	30.0	20.0	13.0	12.0	9.0	8.5	8.0	7.5	7.0	6.5
8.5	30.0	20.0	15.0	12.0	10.0	9.0	8.5	8.0	7.5	7.0
9.0	30.0	20.0	15.0	13.0	11.0	10.0	9.0	8.5	8.0	7.5
10.0	30.0	20.0	20.0	15.0	12.0	11.0	10.0	10.0	9.0	8.0
12.0	40.0	30.0	20.0	20.0	15.0	13.0	12.0	12.0	11.0	10.0

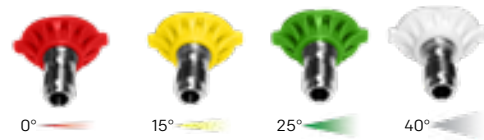

1/4" QC Nozzles

	2.0	2.5	3.0	3.5	4.0	4.5	5.0	5.5	6.0	6.5	7.0	7.5	8.0	8.5	9.0	9.5	10.0
0°	17.0138	17.0145	17.0152	17.0159	17.0166	17.0173	17.0180	17.0187	17.0194	17.0201	17.0546	17.0550	17.0554	17.0558	17.0562	17.0566	17.0570
15°	17.0139	17.0146	17.0153	17.0160	17.0167	17.0174	17.0181	17.0188	17.0195	17.0202	17.0547	17.0551	17.0555	17.0559	17.0563	17.0567	17.0571
25°	17.0140	17.0147	17.0154	17.0161	17.0168	17.0175	17.0182	17.0189	17.0196	17.0203	17.0548	17.0552	17.0556	17.0560	17.0564	17.0568	17.0572
40°	17.0141	17.0148	17.0155	17.0162	17.0169	17.0176	17.0183	17.0190	17.0197	17.0204	17.0549	17.0553	17.0557	17.0561	17.0565	17.0569	17.0573

\$6.65 Each



1/4" Threaded Nozzles

	2.0	2.5	3.0	3.5	4.0	4.5	5.0	5.5	6.0	6.5	7.0	7.5	8.0	8.5	9.0	9.5	10.0
0°	17.0208	17.0212	17.0216	17.0220	17.0224	17.0228	17.0232	17.0236	17.0240	17.0244	17.0602	17.0606	17.0610	17.0614	17.0618	17.0622	17.0626
15°	17.0209	17.0213	17.0217	17.0221	17.0225	17.0229	17.0233	17.0237	17.0241	17.0245	17.0603	17.0607	17.0611	17.0615	17.0619	17.0623	17.0627
25°	17.0210	17.0214	17.0218	17.0222	17.0226	17.0230	17.0234	17.0238	17.0242	17.0246	17.0604	17.0608	17.0612	17.0616	17.0620	17.0624	17.0628
40°	17.0211	17.0215	17.0219	17.0223	17.0227	17.0231	17.0235	17.0239	17.0243	17.0247	17.0605	17.0609	17.0613	17.0617	17.0621	17.0625	17.0629

\$7.20 Each

1/4" QC Nozzle 4 Pack

Part No.	Size	Type Details (Inlet x Outlet)	Max PSI	Max GPM	Max F°	Each
17.0142	2.0	0°, 15°, 25°, 40° 1/4" QC Nozzles	--	--	--	\$31.75
17.0149	2.5	0°, 15°, 25°, 40° 1/4" QC Nozzles	--	--	--	\$31.75
17.0156	3.0	0°, 15°, 25°, 40° 1/4" QC Nozzles	--	--	--	\$31.75
17.0163	3.5	0°, 15°, 25°, 40° 1/4" QC Nozzles	--	--	--	\$31.75
17.0170	4.0	0°, 15°, 25°, 40° 1/4" QC Nozzles	--	--	--	\$31.75
17.0177	4.5	0°, 15°, 25°, 40° 1/4" QC Nozzles	--	--	--	\$31.75
17.0184	5.0	0°, 15°, 25°, 40° 1/4" QC Nozzles	--	--	--	\$31.75
17.0191	5.5	0°, 15°, 25°, 40° 1/4" QC Nozzles	--	--	--	\$31.75
17.0198	6.0	0°, 15°, 25°, 40° 1/4" QC Nozzles	--	--	--	\$31.75
17.0205	6.5	0°, 15°, 25°, 40° 1/4" QC Nozzles	--	--	--	\$31.75
17.0576	7.0	0°, 15°, 25°, 40° 1/4" QC Nozzles	--	--	--	\$31.75
17.0578	7.5	0°, 15°, 25°, 40° 1/4" QC Nozzles	--	--	--	\$31.75
17.0580	8.0	0°, 15°, 25°, 40° 1/4" QC Nozzles	--	--	--	\$31.75
17.0582	8.5	0°, 15°, 25°, 40° 1/4" QC Nozzles	--	--	--	\$31.75
17.0584	9.0	0°, 15°, 25°, 40° 1/4" QC Nozzles	--	--	--	\$31.75
17.0586	9.5	0°, 15°, 25°, 40° 1/4" QC Nozzles	--	--	--	\$31.75
17.0588	10.0	0°, 15°, 25°, 40° 1/4" QC Nozzles	--	--	--	\$31.75



1/4" QC Nozzle 5 Pack

Part No.	Size	Type Details (Inlet x Outlet)	Max PSI	Max GPM	Max F°	Each
17.0143	2.0	0°, 15°, 25°, 40° & 6540 Soap Nozzle	--	--	--	\$34.50
17.0150	2.5	0°, 15°, 25°, 40° & 6540 Soap Nozzle	--	--	--	\$34.50
17.0157	3.0	0°, 15°, 25°, 40° & 6540 Soap Nozzle	--	--	--	\$34.50
17.0164	3.5	0°, 15°, 25°, 40° & 6540 Soap Nozzle	--	--	--	\$34.50
17.0171	4.0	0°, 15°, 25°, 40° & 6540 Soap Nozzle	--	--	--	\$34.50
17.0178	4.5	0°, 15°, 25°, 40° & 6540 Soap Nozzle	--	--	--	\$34.50
17.0185	5.0	0°, 15°, 25°, 40° & 6540 Soap Nozzle	--	--	--	\$34.50
17.0192	5.5	0°, 15°, 25°, 40° & 6540 Soap Nozzle	--	--	--	\$34.50
17.0199	6.0	0°, 15°, 25°, 40° & 6540 Soap Nozzle	--	--	--	\$34.50
17.0206	6.5	0°, 15°, 25°, 40° & 6540 Soap Nozzle	--	--	--	\$34.50
17.0577	7.0	0°, 15°, 25°, 40° & 6540 Soap Nozzle	--	--	--	\$34.50
17.0579	7.5	0°, 15°, 25°, 40° & 6540 Soap Nozzle	--	--	--	\$34.50
17.0581	8.0	0°, 15°, 25°, 40° & 6540 Soap Nozzle	--	--	--	\$34.50
17.0583	8.5	0°, 15°, 25°, 40° & 6540 Soap Nozzle	--	--	--	\$34.50
17.0585	9.0	0°, 15°, 25°, 40° & 6540 Soap Nozzle	--	--	--	\$34.50
17.0587	9.5	0°, 15°, 25°, 40° & 6540 Soap Nozzle	--	--	--	\$34.50
17.0589	10.0	0°, 15°, 25°, 40° & 6540 Soap Nozzle	--	--	--	\$34.50



Stainless Fixed Sewer Nozzles

Part No.	Size	Type Details (Inlet x Outlet)	Max PSI	Max GPM	Max F°	Each
17.0825	4.0	1/8" NPTF 3 Back + 1 Forward	5,000	--	--	\$10.25
17.0827	5.0	1/8" NPTF 3 Back + 1 Forward	5,000	--	--	\$10.25
17.0828	5.5	1/8" NPTF 3 Back + 1 Forward	5,000	--	--	\$10.25
17.0829	6.0	1/8" NPTF 3 Back + 1 Forward	5,000	--	--	\$10.25
17.0835	4.5	1/4" NPTF 3 Back + 1 Forward	5,000	--	--	\$12.60
17.0837	5.5	1/4" NPTF 3 Back + 1 Forward	5,000	--	--	\$12.60
17.0839	6.5	1/4" NPTF 3 Back + 1 Forward	5,000	--	--	\$12.60
17.0840	7.0	1/4" NPTF 3 Back + 1 Forward	5,000	--	--	\$12.60
17.0841	8.0	1/4" NPTF 3 Back + 1 Forward	5,000	--	--	\$12.60
17.0860	9.5	1/4" NPTF 3 Back + 1 Forward	5,000	--	--	\$21.80
17.0842	12.0	1/4" NPTF 3 Back + 1 Forward	5,000	--	--	\$12.60
17.0844	4.5	3/8" NPFT 3 Back + 1 Forward	5,000	--	--	\$14.90
17.0846	5.5	3/8" NPFT 3 Back + 1 Forward	5,000	--	--	\$14.90
17.0848	6.5	3/8" NPFT 3 Back + 1 Forward	5,000	--	--	\$14.90
17.0850	8.0	3/8" NPFT 3 Back + 1 Forward	5,000	--	--	\$14.90
17.0851	12.0	3/8" NPFT 3 Back + 1 Forward	5,000	--	--	\$14.90

Stainless w/ Brass Rotating Sewer Nozzles

Part No.	Size	Type Details (Inlet x Outlet)	Max PSI	Max GPM	Max F°	Each
17.0020	4.5	1/8" NPTF 3 Back	3,000	--	--	\$22.10
17.0852	5.5	1/8" NPTF 3 Back	3,000	--	--	\$22.60
17.0019	4.5	1/4" NPTF 3 Back	3,000	--	--	\$23.10
17.0853	5.5	1/4" NPTF 3 Back	3,000	--	--	\$23.10
17.0021	8.5	3/8" NPTF 3 Back	3,000	--	--	\$23.10

Brass Turbo Sewer Nozzles

Part No.	Size	Type Details (Inlet x Outlet)	Max PSI	Max GPM	Max F°	Each
16.0354	4.0	1/8" NPTF .98" DIAMETER 3 Back + 1 Up Rotating	2,175	--	--	\$356.70
16.0355	6.0	1/8" NPTF .98" DIAMETER 3 Back + 1 Up Rotating	2,175	--	--	\$356.70
41.0843	4.0 Repair Kit	.98" DIAMETER 3 Back + 1 Up Rotating	--	--	--	\$132.50
41.0844	6.0 Repair Kit	.98" DIAMETER 3 Back + 1 Up Rotating	--	--	--	\$132.50

Soap Nozzles

Part No.	Type	Type Details (Inlet x Outlet)	Max PSI	Max GPM	Max F°	Each
17.0024	Brass	1/4" NPTM 6540	--	--	--	\$3.60
17.0025	Brass	1/4" QC 6540	--	--	--	\$3.60

Steam Nozzle

Part No.	Type	Type Details (Inlet x Outlet)	Max PSI	Max GPM	Max F°	Each
17.0023	Brass	1/4" NPTF - Flat	1,450	--	265°F	\$16.90

Nozzle Cleaners

Part No.	Type	Type Details (Inlet x Outlet)	Max PSI	Max GPM	Max F°	Each
17.0702	Plastic	1/4" QC	--	--	--	\$2.85
17.0703	Brass	1/4" QC	--	--	--	\$11.80

Nozzle Protectors

Part No.	Type	Type Details (Inlet x Outlet)	Max PSI	Max GPM	Max F°	Each
22.0211	Blue & Grey	1/4" Deluxe 3 Piece	--	--	--	\$7.95
41.0090	Black	1/4" Deluxe 3 Piece	--	--	--	\$6.95
41.0091	Black	1/4" 2 Piece	--	--	--	\$4.35

Lance Socket

Part No.	Type	Type Details (Inlet x Outlet)	Max PSI	Max GPM	Max F°	Each
38.0001	Lance Socket	1/4" NPTF x 1/4" NPTF	3,700	--	--	\$5.40

Dual Rollover Nozzle Holder

Part No.	Type	Type Details (Inlet x Outlet)	Max PSI	Max GPM	Max F°	Each
16.0129	Nozzle Holder	1/4" NPTF x 1/4" NPTF - 1/4" NPTF	3,200	10.5	195°F	\$19.80

Hi Lo Trombone Valve

Part No.	Type	Type Details (Inlet x Outlet)	Max PSI	Max GPM	Max F°	Each
20.0073		1/4" NPTF x 1/4" NPTF - 1/4" NPTF	4,000	8	195°F	\$36.50

Adjustable Hyperjet Pressure Nozzle

Part No.	Type	Type Details (Inlet x Outlet)	Max PSI	Max GPM	Max F°	Each
16.0061		1/4" NPTF x 1/4" NPTF w/ Nozzle Protector	3,600	--	300°F	\$35.75
16.0062		1/4" NPTF x 1/4" NPTF	3,600	--	300°F	\$31.00





Hi Lo Variable Nozzle

Part No.	Size	Product Details (Inlet x Outlet)	Max PSI	Max GPM	Max F°	Each
16.0017	Not Included	1/4" FPT - Orifice Not Included	3,000	--	300°F	\$22.30
16.0001	1.1 mm	1/4" FPT - 3.0 Orifice - ○ White	3,000	--	300°F	\$24.10
16.0002	1.2 mm	1/4" FPT - 3.5 Orifice - ● Yellow	3,000	--	300°F	\$24.10
16.0003	1.3 mm	1/4" FPT - 4.5 Orifice - ● Orange	3,000	--	300°F	\$24.10
16.0004	1.4 mm	1/4" FPT - 5.0 Orifice - ● Red	3,000	--	300°F	\$24.10
16.0005	1.5 mm	1/4" FPT - 5.5 Orifice - ● Blue	3,000	--	300°F	\$24.10
16.0006	1.6 mm	1/4" FPT - 6.5 Orifice - ● Black	3,000	--	300°F	\$24.10
16.0007	1.7 mm	1/4" FPT - 7.5 Orifice - ● Brown	3,000	--	300°F	\$24.10
16.0008	1.8 mm	1/4" FPT - 8.0 Orifice - ● Green	3,000	--	300°F	\$24.10
17.0001	Replacement	1.1 mm - 3.0 Orifice - ○ White	--	--	--	\$3.60
17.0002	Replacement	1.2 mm - 3.5 Orifice - ● Yellow	--	--	--	\$3.60
17.0003	Replacement	1.3 mm - 4.5 Orifice - ● Orange	--	--	--	\$3.60
17.0004	Replacement	1.4 mm - 5.0 Orifice - ● Red	--	--	--	\$3.60
17.0005	Replacement	1.5 mm - 5.5 Orifice - ● Blue	--	--	--	\$3.60
17.0006	Replacement	1.6 mm - 6.5 Orifice - ● Black	--	--	--	\$3.60
17.0007	Replacement	1.7 mm - 7.5 Orifice - ● Brown	--	--	--	\$3.60
17.0008	Replacement	1.8 mm - 8.0 Orifice - ● Green	--	--	--	\$3.60

Hi Lo Variable Nozzle Extension

Part No.	Size	Product Details (Inlet x Outlet)	Max PSI	Max GPM	Max F°	Each
14.0337	18"	Non Molded Plated Steel M22M x 1.1 mm	3,000	--	300°F	\$36.00
14.0296	18"	Non Molded Plated Steel M22M x 1.2 mm	3,000	--	300°F	\$36.00
14.0338	18"	Non Molded Plated Steel M22M x 1.3 mm	3,000	--	300°F	\$36.00

Water Brooms

Part No.	Size	Type Details (Inlet x Outlet)	Max PSI	Max GPM	Max F°	Each
22.0100	12"	3 Nozzle Ports (Nozzles Not Included)	--	--	--	\$68.75
22.0101	16"	4 Nozzle Ports (nozzles Not Included)	--	--	--	\$82.00
22.0402	12"	3 Nozzles Installed	--	--	--	\$99.50
22.0403	12"	3 Nozzles Installed w/ 1/4" QC Inlet	--	--	--	\$101.00
22.0404	12"	3 Nozzles Installed w/ M22 M Inlet	--	--	--	\$103.50
22.0405	16"	4 Nozzles Installed	--	--	--	\$101.00
22.0406	16"	4 Nozzles Installed w/ 1/4" QC Inlet	--	--	--	\$114.50
22.0407	16"	4 Nozzles Installed w/ M22 M Inlet	--	--	--	\$116.50

3,700 Max PSI Turbo Nozzles

Part No.	Size	Product Details (Inlet x Outlet)	Max PSI	Max GPM	Max F°	Each
16.0068	2.0	1/4" NPTF	3,700	--	195°	\$152.10
16.0069	2.5	1/4" NPTF	3,700	--	195°	\$152.10
16.0070	3.0	1/4" NPTF	3,700	--	195°	\$152.10
16.0071	3.5	1/4" NPTF	3,700	--	195°	\$152.10
16.0072	4.0	1/4" NPTF	3,700	--	195°	\$152.10
16.0073	4.5	1/4" NPTF	3,700	--	195°	\$152.10
16.0074	5.0	1/4" NPTF	3,700	--	195°	\$152.10
16.0075	5.5	1/4" NPTF	3,700	--	195°	\$152.10
16.0076	6.0	1/4" NPTF	3,700	--	195°	\$152.10
16.0077	6.5	1/4" NPTF	3,700	--	195°	\$152.10
41.0051	2.0 Repair Kit	Rotor, Seat & O-Ring	3,700	--	195°	\$103.10
41.0052	2.5 Repair Kit	Rotor, Seat & O-Ring	3,700	--	195°	\$103.10
41.0053	3.0 Repair Kit	Rotor, Seat & O-Ring	3,700	--	195°	\$103.10
41.0054	3.5 Repair Kit	Rotor, Seat & O-Ring	3,700	--	195°	\$103.10
41.0055	4.0 Repair Kit	Rotor, Seat & O-Ring	3,700	--	195°	\$103.10
41.0056	4.5 Repair Kit	Rotor, Seat & O-Ring	3,700	--	195°	\$103.10
41.0057	5.0 Repair Kit	Rotor, Seat & O-Ring	3,700	--	195°	\$103.10
41.0058	5.5 Repair Kit	Rotor, Seat & O-Ring	3,700	--	195°	\$103.10
41.0059	6.0 Repair Kit	Rotor, Seat & O-Ring	3,700	--	195°	\$103.10
41.0060	6.5 Repair Kit	Rotor, Seat & O-Ring	3,700	--	195°	\$103.10

4,000 Max PSI Turbo Nozzles

Part No.	Size	Product Details (Inlet x Outlet)	Max PSI	Max GPM	Max F°	Each
16.0221	2.5	1/4" NPTF	4,000	--	195°	\$137.00
16.0222	3.0	1/4" NPTF	4,000	--	195°	\$137.00
16.0223	3.5	1/4" NPTF	4,000	--	195°	\$137.00
16.0224	4.0	1/4" NPTF	4,000	--	195°	\$137.00
16.0225	4.5	1/4" NPTF	4,000	--	195°	\$137.00
16.0226	5.0	1/4" NPTF	4,000	--	195°	\$137.00
16.0227	5.5	1/4" NPTF	4,000	--	195°	\$137.00
16.0228	6.0	1/4" NPTF	4,000	--	195°	\$137.00
16.0339	8.0	1/4" NPTF	4,000	--	195°	\$137.00
41.0374	2.5 Repair Kit	Rotor, Seat & O-Ring	4,000	--	195°	\$68.75
41.0375	3.0 Repair Kit	Rotor, Seat & O-Ring	4,000	--	195°	\$68.75
41.0376	3.5 Repair Kit	Rotor, Seat & O-Ring	4,000	--	195°	\$68.75
41.0377	4.0 Repair Kit	Rotor, Seat & O-Ring	4,000	--	195°	\$68.75
41.0378	4.5 Repair Kit	Rotor, Seat & O-Ring	4,000	--	195°	\$68.75
41.0379	5.0 Repair Kit	Rotor, Seat & O-Ring	4,000	--	195°	\$68.75
41.0380	5.5 Repair Kit	Rotor, Seat & O-Ring	4,000	--	195°	\$68.75
41.0381	6.0 Repair Kit	Rotor, Seat & O-Ring	4,000	--	195°	\$68.75
41.0802	8.0 Repair Kit	Rotor, Seat & O-Ring	4,000	--	195°	\$68.75





4,000 Max PSI Turbo Nozzles With High Pressure Filter Installed

Part No.	Size	Product Details (Inlet x Outlet)	Max PSI	Max GPM	Max F°	Each
16.0295	3.0	1/4" NPTF W/ 1/4" QC H.P. Filter	4,000	--	195°	\$159.00
16.0296	3.5	1/4" NPTF W/ 1/4" QC H.P. Filter	4,000	--	195°	\$159.00
16.0297	4.0	1/4" NPTF W/ 1/4" QC H.P. Filter	4,000	--	195°	\$159.00
16.0298	4.5	1/4" NPTF W/ 1/4" QC H.P. Filter	4,000	--	195°	\$159.00

High Pressure Filter

Part No.	Type	Product Details (Inlet x Outlet)	Max PSI	Max GPM	Max F°	Each
16.0046	Installed Filter	QC High Pressure Filter Upgrade (23.0014 Installed On Turbo Nozzle)				\$23.00
23.0013	w/o Plug	1/4" NPTF x 1/4" NPTM	6,000	--	300°	\$19.00
23.0014	w/ Plug	1/4" M QC Plug x 1/4" NPTM	6,000	--	300°	\$20.50
41.0035	Repair Kit	HP Filter Repair Kit For Items 23.0013 & 23.0014	--	--	--	\$11.30

5,000 Max PSI Turbo Nozzles

Part No.	Size	Product Details (Inlet x Outlet)	Max PSI	Max GPM	Max F°	Each
16.0078	3.0	1/4" NPTF	5,000	--	195°	\$201.60
16.0079	3.5	1/4" NPTF	5,000	--	195°	\$201.60
16.0080	4.0	1/4" NPTF	5,000	--	195°	\$201.60
16.0081	4.5	1/4" NPTF	5,000	--	195°	\$201.60
16.0082	5.0	1/4" NPTF	5,000	--	195°	\$201.60
16.0083	5.5	1/4" NPTF	5,000	--	195°	\$201.60
16.0084	6.0	1/4" NPTF	5,000	--	195°	\$201.60
16.0085	6.5	1/4" NPTF	5,000	--	195°	\$201.60
16.0086	7.0	1/4" NPTF	5,000	--	195°	\$201.60
41.0061	3.0 Repair Kit	Rotor, Seat & O-Ring	5,000	--	195°	\$133.00
41.0062	3.5 Repair Kit	Rotor, Seat & O-Ring	5,000	--	195°	\$133.00
41.0063	4.0 Repair Kit	Rotor, Seat & O-Ring	5,000	--	195°	\$133.00
41.0064	4.5 Repair Kit	Rotor, Seat & O-Ring	5,000	--	195°	\$133.00
41.0065	5.0 Repair Kit	Rotor, Seat & O-Ring	5,000	--	195°	\$133.00
41.0066	5.5 Repair Kit	Rotor, Seat & O-Ring	5,000	--	195°	\$133.00
41.0067	6.0 Repair Kit	Rotor, Seat & O-Ring	5,000	--	195°	\$133.00
41.0068	6.5 Repair Kit	Rotor, Seat & O-Ring	5,000	--	195°	\$133.00
41.0069	7.0 Repair Kit	Rotor, Seat & O-Ring	5,000	--	195°	\$133.00

5,800 Max PSI Hydro Excavating Turbo Nozzles

Part No.	Size	Product Details (Inlet x Outlet)	Max PSI	Max GPM	Max F°	Each
16.0375	10.0	1/4" NPTF	5,800	--	195°	\$409.30
16.0377	12.0	1/4" NPTF	5,800	--	195°	\$409.30

5,800 Max PSI Turbo Nozzles

Part No.	Size	Product Details (Inlet x Outlet)	Max PSI	Max GPM	Max F°	Each
16.0090	3.0	1/4" NPTF	5,800	--	195°	\$352.60
16.0091	3.5	1/4" NPTF	5,800	--	195°	\$352.60
16.0092	4.0	1/4" NPTF	5,800	--	195°	\$352.60
16.0093	4.5	1/4" NPTF	5,800	--	195°	\$352.60
16.0094	5.0	1/4" NPTF	5,800	--	195°	\$352.60
16.0095	5.5	1/4" NPTF	5,800	--	195°	\$352.60
16.0096	6.0	1/4" NPTF	5,800	--	195°	\$352.60
16.0097	6.5	1/4" NPTF	5,800	--	195°	\$352.60
16.0098	7.0	1/4" NPTF	5,800	--	195°	\$352.60
16.0099	7.5	1/4" NPTF	5,800	--	195°	\$352.60
16.0100	8.0	1/4" NPTF	5,800	--	195°	\$352.60
16.0101	9.0	1/4" NPTF	5,800	--	195°	\$352.60
16.0087	10.0	1/4" NPTF	5,800	--	195°	\$352.60
16.0102	11.0	1/4" NPTF	5,800	--	195°	\$352.60
16.0088	12.0	1/4" NPTF	5,800	--	195°	\$352.60
16.0344	15.0	1/4" NPTF	5,800	--	195°	\$414.40
16.0345	18.0	1/4" NPTF	5,800	--	195°	\$414.40
16.0346	20.0	1/4" NPTF	5,800	--	195°	\$414.40
41.0072	3.0 Repair Kit	Rotor, Seat & O-Ring	5,800	--	195°	\$143.30
41.0073	3.5 Repair Kit	Rotor, Seat & O-Ring	5,800	--	195°	\$143.30
41.0074	4.0 Repair Kit	Rotor, Seat & O-Ring	5,800	--	195°	\$143.30
41.0075	4.5 Repair Kit	Rotor, Seat & O-Ring	5,800	--	195°	\$143.30
41.0076	5.0 Repair Kit	Rotor, Seat & O-Ring	5,800	--	195°	\$143.30
41.0077	5.5 Repair Kit	Rotor, Seat & O-Ring	5,800	--	195°	\$143.30
41.0078	6.0 Repair Kit	Rotor, Seat & O-Ring	5,800	--	195°	\$143.30
41.0079	6.5 Repair Kit	Rotor, Seat & O-Ring	5,800	--	195°	\$143.30
41.0080	7.0 Repair Kit	Rotor, Seat & O-Ring	5,800	--	195°	\$143.30
41.0081	7.5 Repair Kit	Rotor, Seat & O-Ring	5,800	--	195°	\$143.30
41.0082	8.0 Repair Kit	Rotor, Seat & O-Ring	5,800	--	195°	\$143.30
41.0083	9.0 Repair Kit	Rotor, Seat & O-Ring	5,800	--	195°	\$143.30
41.0070	10.0 Repair Kit	Rotor, Seat & O-Ring	5,800	--	195°	\$143.30
41.0085	11.0 Repair Kit	Rotor, Seat & O-Ring	5,800	--	195°	\$143.30
41.0071	12.0 Repair Kit	Rotor, Seat & O-Ring	5,800	--	195°	\$143.30
41.0817	15.0 Repair Kit	Rotor, Seat & O-Ring	5,800	--	195°	\$232.00
41.0818	18.0 Repair Kit	Rotor, Seat & O-Ring	5,800	--	195°	\$242.50
41.0819	20.0 Repair Kit	Rotor, Seat & O-Ring	5,800	--	195°	\$232.00



PF22 FOAM CANNON

Innovation Design Quality

The Innovation of the PF22 Foam Cannon lies in the nozzle. This foam cannon offers not only adjustable fan blades but now offers an adjustable spray pattern (vertically or horizontally) as it throws thick foam onto your vehicle, house, fence, sidewalk, roof or other washable items. The chemical injection knob on top allows for more or less chemical to be drawn through the internal chamber, increasing or decreasing the foam output. This allows the internal agitator to create a dense foam.



M22 and QC Plug Fittings Included



*** Starting Summer 2018 Pricing and Description Will Be In Effect ***

Professional Foam Cannon has a 1.25 mm orifice installed, and will come with an additional 1.1 mm orifice included.

PF22 Foam Cannon

Part No.	Size	Product Details (Inlet x Outlet)	Max PSI	Max GPM	Max F°	Each
14.5001	1.25 mm Installed 1.1 mm Included	1/4" Plug, M22, Tube, & Bottle	1,100-5,000	1.8-5.3	140°	\$206.25

Magnum Foam Kit

Part No.	Size	Product Details (Inlet x Outlet)	Max PSI	Max GPM	Max F°	Each
14.5008	1.25 mm	1/4" Plug, M22, Tube, & Bottle	1,100-5,000	1.8-5.3	140°	\$299.00

PF22 Foam Cannon Replacements

Part No.	Size	Product Details (Inlet x Outlet)	Max PSI	Max GPM	Max F°	Each
37.0451	1 Liter	Replacement Bottle	--	--	--	\$16.50
41.5001	PF22 Repair Kit	Filter, Pin, & O-Rings	--	--	--	\$26.75





Snub Gun Foam Kit

Part No.	Packaging	Type Details (Inlet x Outlet)	Max PSI	Max GPM	Max F°	Each
14.5005	Individual	M407 Spray Gun, & Foam Cannon	4,000	5.3	140°F	\$183.00

*** Starting Summer 2018 Pricing and Description Will Be In Effect ***
 Professional Foam Cannon has a 1.25 mm orifice installed, and will come with an additional 1.1 mm orifice included.

The Original Professional Foam Cannon

Part No.	Size	Product Details (Inlet x Outlet)	Max PSI	Max GPM	Max F°	Each
14.0263	1.25 mm Installed 1.1 mm Included	1/4" Plug, M22, Tube, & Bottle	1,100-5,000	1.8-5.3	140°	\$180.50



Featherweight Foam Cannon

Part No.	Size	Product Details (Inlet x Outlet)	Max PSI	Max GPM	Max F°	Each
14.5006	1.25 mm	Teflon Wrapped 1/4" Plug, Tube, & Bottle	1,100-2,600	1.4-2.4	140°	\$79.50

Professional Foam Jet Kit

Part No.	Size	Product Details (Inlet x Outlet)	Max PSI	GPM	Max F°	Each
14.0289	Optional	33' Hose w/ Chemical Filter	5,000	7	250°	\$242.30

Install One Of The Below Orifices Based Upon GPM & PSI Ratings

Not Installed - Stainless 1.25 mm - 3.5 (Yellow) Orifice	3,000	2.5-3.0	--	--
Not Installed - Stainless 1.5 mm - 5.0 (Red) Orifice	4,000	3.5-4.0	--	--
Not Installed - Stainless 1.7 mm - 6.5 (Black) Orifice	5,000	5.0-5.6	--	--

Foam Cannon Replacement Parts

Part No.	Size	Product Details (Inlet x Outlet)	Max PSI	Max GPM	Max F°	Each
36.5000	1.1 mm	3.0 Orifice	--	--	--	\$18.50
36.0227	1.25 mm	3.5 Orifice	--	--	--	\$18.50
36.0235	1.5 mm	5.0 Orifice	--	--	--	\$18.50
36.0236	1.7 mm	6.5 Orifice	--	--	--	\$18.50
37.0253	1 Liter	Replacement Bottle	--	--	--	\$12.10
37.0451	1 Liter	Upgraded Replacement Bottle	--	--	--	\$16.50
41.0338		Replacement Suction Tube	--	--	--	\$19.00
36.0226	Filter	Replacement Filter (All Foamers)	--	--	--	\$10.00
41.0400	Repair Kit	4 O-Rings, & Stainless Filter	--	--	--	\$23.30
41.0401	Replacemnt	33' Hose w/ Chemical Filter	--	--	--	\$70.00

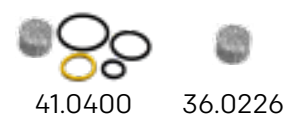

Professional Sand Blast Kit

Part No.	Size	Product Details (Inlet x Outlet)	Max PSI	Max GPM	Max F°	Each
16.0204	--	Professional Sandblast Kit Without Nozzle			195°	\$199.00
16.0206	1.00 mm	2.0 Orifice			195°	\$205.50
16.0207	1.20 mm	3.0 Orifice			195°	\$205.50
16.0208	1.30 mm	3.5 Orifice			195°	\$205.50
16.0209	1.40 mm	4.0 Orifice			195°	\$205.50
16.0210	1.50 mm	4.5 Orifice			195°	\$205.50
16.0211	1.60 mm	5.0 Orifice			195°	\$205.50
16.0212	1.70 mm	6.0 Orifice			195°	\$205.50
17.0875	Replacement	1.00 mm - 2.0 Orifice w/ O-Ring				\$6.65
17.0876	Replacement	1.20 mm - 3.0 Orifice w/ O-Ring				\$6.65
17.0877	Replacement	1.30 mm - 3.5 Orifice w/ O-Ring				\$6.65
17.0878	Replacement	1.40 mm - 4.0 Orifice w/ O-Ring				\$6.65
17.0879	Replacement	1.50 mm - 4.5 Orifice w/ O-Ring				\$6.65
17.0880	Replacement	1.60 mm - 5.0 Orifice w/ O-Ring				\$6.65
17.0881	Replacement	1.70 mm - 6.0 Orifice w/ O-Ring				\$6.65
41.0357	Replacement	Brass Nozzle Holder w/ Tungsten Nozzle				\$57.25
41.0358	Replacement	Ø13, 1x2, 62 O-Rings				\$1.30
41.0360	Replacement	1/4" BSP Blocking Nozzle Plug				\$1.55
41.0363	Replacement	20" Sand Probe				\$12.80



Industrial Sand Blast Kit

Part No.	Size	Product Details (Inlet x Outlet)	Max PSI	Max GPM	Max F°	Each
16.0117	Nozzle Not Included	1/4" Plug (Inlet) - 25 ft. Hose	3,000-5,000	4-8	195°	\$280.00
A 1/4" 0° Threaded Nozzle (Not Included) Is Required For The Industrial Sand Blast Kit To Function Properly. See Nozzle Selection Chart On Page 12 To Properly Select The Correct 1/4" 0° Threaded Nozzle						
16.0118	Replacement	Sand Blast Head	--	--	--	\$66.25
16.0119	Replacement	1/8" M Sand Valve	--	--	--	\$7.20
16.0121	Replacement	Tungsten Carbide Nozzle	--	--	--	\$102.50
16.0123	Replacement	Gasket	--	--	--	\$2.85
16.0124	Replacement	Sand Probe	--	--	--	\$52.50
16.0127	Replacement	3/4" x 3.5 mm x25' Nylonbraided Hose	--	--	--	\$53.75
16.0128	Replacement	1/4" QC x 1/4" F Nozzle Holder	--	--	--	\$8.20

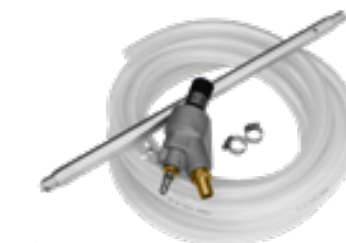

Assembly Instructions

Pre-Installed Items

- Item #4 & #5 are already pre-installed into item #1
- Item #2 is already pre-installed into item #1

Install The Following Items

- Install the appropriate sized 1/4" 0° threaded spray nozzle (**NOT INCLUDED**) into item #10 (SEE RIGHT DIAGRAM)
- Securely install item #10 in rear of item #1, lock item #10 in place using item #3
- Install item #7 in top port of item #1
- Connect item #6 & #7 to each end of item #9
- Secure item #9 in place with the clamps provided (#8)

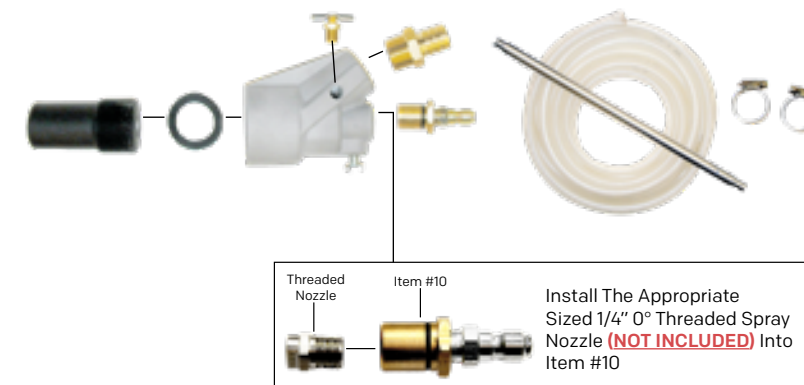



Unloader Mounting Blocks

Part No.	Type	Product Details (Inlet x Outlet)	Max PSI	Max GPM	Max F°	Each
22.0103	Brass	3/8" NPTF x 3/8" NPTF	4,000	--	--	\$52.50
22.0104	Brass	1/2" NPTF x 1/2" NPTF	4,000	--	--	\$52.50
22.0292	Nickle Plated Steel	3/8" NPTF x 3/8" NPTF	4,000	--	--	\$24.60
22.0294	Nickle Plated Steel	1/2" NPTF x 1/2" NPTF	4,000	--	--	\$25.75

MG4000 Unloaders

Part No.	Type	Product Details (Inlet x Outlet)	Max PSI	Max GPM	Max F°	Each
18.0161	Microswitch	3/8" NPTF x 3/8" NPTF - 3/8" F ByPass 250 V - 15 A	● 3,000	10.5	195°	\$198.00
18.0164	Microswitch	3/8" NPTF x 3/8" NPTF - 3/8" F ByPass 250 V - 15 A	● 4,000	10.5	195°	\$198.00
18.0167	Microswitch	3/8" NPTF x 3/8" NPTF - 3/8" F ByPass 250 V - 15 A	● 4,500	10.5	195°	\$198.00
18.0296	w/ Handle	3/8" NPTF x 3/8" NPTF - 3/8" F ByPass	● 1,500	10.5	195°	\$151.50
18.0299	w/ Handle	3/8" NPTF x 3/8" NPTF - 3/8" F ByPass	● 3,000	10.5	195°	\$151.50
18.0303	w/ Handle	3/8" NPTF x 3/8" NPTF - 3/8" F ByPass	● 4,000	10.5	195°	\$151.50
18.0307	w/ Handle	3/8" NPTF x 3/8" NPTF - 3/8" F ByPass	● 4,500	10.5	195°	\$151.50
41.0032	Repair Kit	MG4000 Unloader Repair Kit	--	--	--	\$46.50

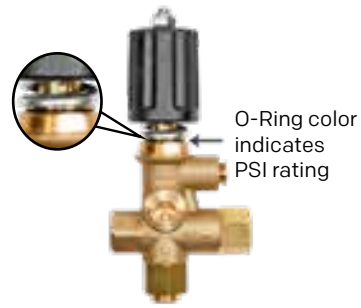

Chemical Injectors

Part No.	Type	Product Details (Inlet x Outlet)	Max PSI	Max GPM	Max F°	Each
22.0314	Fixed	3/8" NPTM x 3/8" NPTM - 1.8 mm	3,600	2-3.8	300°	\$19.00
22.0315	Fixed	3/8" NPTM x 3/8" NPTM - 2.1 mm	3,600	2.7-4.9	300°	\$19.00
22.0316	Fixed	3/8" NPTM x 3/8" NPTM - 2.3 mm	3,600	3.3-6.5	300°	\$19.00
22.0317	Adjustable	3/8" NPTM x 3/8" NPTM - 1.8 mm	3,600	2-3.8	300°	\$25.75
22.0318	Adjustable	3/8" NPTM x 3/8" NPTM - 2.1 mm	3,600	2.7-4.9	300°	\$25.75
22.0319	Adjustable	3/8" NPTM x 3/8" NPTM - 2.3 mm	3,600	3.3-6.5	300°	\$25.75
22.0320	Acid Fixed	3/8" NPTM x 3/8" NPTM - 1.8 mm	3,600	2-3.8	300°	\$24.10
22.0321	Acid Fixed	3/8" NPTM x 3/8" NPTM - 2.1 mm	3,600	2.7-4.9	300°	\$24.10
22.0322	Acid Fixed	3/8" NPTM x 3/8" NPTM - 2.3 mm	3,600	3.3-6.5	300°	\$24.10
22.0323	Acid Adjustable	3/8" NPTM x 3/8" NPTM - 1.8 mm	3,600	2-3.8	300°	\$31.00
22.0324	Acid Adjustable	3/8" NPTM x 3/8" NPTM - 2.1 mm	3,600	2.7-4.9	300°	\$31.00
22.0325	Acid Adjustable	3/8" NPTM x 3/8" NPTM - 2.3 mm	3,600	3.3-6.5	300°	\$31.00
22.0326	Repair Kit	Standard & Acid Repair Kit				\$11.50



Pressure Relief Valve MG1000

Part No.	Type	Product Details (Inlet x Outlet)	Max PSI	Max GPM	Max F°	Each
19.0004		3/8" NPTM x 6mm Hose Barb	3,600	8	195°	\$50.75



Thermal Relief Valves

Part No.	Type	Product Details (Inlet x Outlet)	Max PSI	Max GPM	Open Max F°	Each
20.0020	TRV	3/8" NPTM x 7mm Hose Barb	145	--	135°	\$33.25
20.0021	TRV	1/2" NPTM x 7mm Hose Barb	145	--	135°	\$35.25
20.0069		1/4" NPTM	145	--	150°	\$10.25
20.0070		3/8" NPTM	145	--	150°	\$12.80
20.0071		1/2" NPTM	145	--	150°	\$16.40



Easy Start Valve

Part No.	Type	Product Details (Inlet x Outlet)	Max PSI	Max GPM	Max F°	Each
20.0018		3/8" BSPM	4,100	8	195°	\$44.50



Chemical Metering Valve

Part No.	Type	Product Details (Inlet x Outlet)	Max PSI	Max GPM	Max F°	Each
20.0034	T-Valve	1/4" NPTF x 1/4" NPTF	4,000	3	300°	\$34.50
22.0120		1/4" BSPF x 1/4" BSPF	440	3	100°	\$43.25





Ball Valves

Part No.	Type	Product Details (Inlet x Outlet)	Max PSI	Max GPM	Max F°	Each
20.0035	Plated Steel	1/4" NPTF x 1/4" NPTF - 6 mm Hole	7,000	--	176°	\$68.75
20.0036	Plated Steel	3/8" NPTF x 3/8" NPTF - 10 mm Hole	7,000	--	176°	\$72.25
20.0037	Plated Steel	1/2" NPTF x 1/2" NPTF - 12 mm Hole	7,000	--	176°	\$77.50
20.5002	Plated Steel	3/4" NPTF x 3/4" NPTF - 20 mm Hole	6,000	--	215°	\$159.00
20.0042	w/ Plug & QC	1/4" NPTF x 1/4" NPTF - 6 mm Hole	5,500	--	176°	\$77.50
20.0043	w/ Plug & QC	3/8" NPTF x 3/8" NPTF - 10 mm Hole	4,200	--	176°	\$84.00
20.0044	w/ Plug & QC	1/2" NPTF x 1/2" NPTF - 12 mm Hole	3,600	--	176°	\$84.25
41.0099	Replacement	Zinc Plated Replacement Handle	--	--	--	\$6.40



Ball Valves

Part No.	Type	Product Details (Inlet x Outlet)	Max PSI	Max GPM	Max F°	Each
20.0027	Brass	1/4" NPTF x 1/4" NPTF - 10 mm Hole	600	--	266°	\$16.80
20.0029	Brass	1/2" NPTF x 1/2" NPTF - 15 mm Hole	600	--	266°	\$19.30
20.0030	Brass	3/4" NPTF x 3/4" NPTF - 20 mm Hole	600	--	266°	\$29.60
20.0032	Brass	3/8" BSPF x 3/8" BSPF - 8 mm Hole	3,000	--	176°	\$112.40
20.0033	Brass	1/2" BSPF x 1/2" BSPF - 12 mm Hole	3,000	--	176°	\$140.70
20.0038	Stainless	1/4" NPTF x 1/4" NPTF	6,000	--	176°	\$102.00
20.0039	Stainless	3/8" NPTF x 3/8" NPTF	6,000	--	176°	\$176.00
20.0040	Stainless	1/2" NPTF x 1/2" NPTF	6,000	--	176°	\$182.50
41.0698	Replacement	6,000 PSI Ball Valve Handle	--	--	--	\$11.50

Float Valves

Part No.	Type	Product Details (Inlet x Outlet)	Max PSI	Dim.	Max F°	Each
22.0001	Plastic	3/4" NPTM - No Filter - No Pipe	145	7.8"	140°	\$30.90
22.0010	Plastic	3/4" NPTM - w/ Filter - No Pipe	145	7.8"	140°	\$30.70
22.0011	Plastic	3/4" NPTM - No Filter - w/ Pipe	145	7.8"	140°	\$32.00
22.0012	Plastic	3/4" NPTM - w/ Filter - w/ Pipe	145	7.8"	140°	\$32.00
22.0014	Brass	3/4" NPTM - w/ Filter - w/ Pipe	105	9.4"	140°	\$61.30
22.0015	Brass	3/4" NPTM - No Filter - No Pipe	105	9.4"	140°	\$61.10
22.0017	Brass	1/2" NPTM - No Filter - No Pipe	105	9.4"	140°	\$57.50
22.0018	Brass	1/2" NPTM - No Filter - w/ Pipe	105	9.4"	140°	\$56.70
41.0003	Repair Kit	Brass Float Valve Repair Kit	--	--	--	\$22.30



Float Tank

Part No.	Type	Product Details (Inlet x Outlet)	Dim.	Capacity	Max F°	Each
22.0065	Plastic	No Bulkhead - w/ Cover	140°	0.8 Gal.	140°	\$23.10
22.0066	Plastic	w/ Bulkhead & Cover	5"x10"x8"	0.8 Gal.	140°	\$24.90



Chemical Filter

Part No.	Type	Product Details (Inlet x Outlet)	Max PSI	Max GPM	Max F°	Each
23.0001	Plastic	Hose Barb 6-8 - No Check Valve	--	--	--	\$3.60
23.0002	Plastic	Hose Barb 6-8 - w/ Check Valve	--	--	--	\$6.40
23.0003	Plastic	Hose Barb 6-8 - w/ Check Valve & Spring	--	--	--	\$6.95
23.0061	Brass Chrome Plated	Hose Barb 6-8 - w/ Check Valve	--	--	--	\$4.10
23.0068	Stainless Filter Brass Body	Hose Barb 6mm - w/ Check Valve	--	--	--	\$9.75
23.0065	Assembly	4' (Hose) Filter w/ Spring Check Valve	--	--	--	\$5.15



23.0061

23.0068

Y Inlet Filter

Part No.	Type	Product Details (Inlet x Outlet)	Max PSI	Max GPM	Max F°	Each
23.0090	Brass	1/2" NPTF x 1/2" NPTF - 400 Micron	290	--	--	\$16.90
23.0091	Brass	3/4" NPTF x 3/4" NPTF - 400 Micron	290	--	--	\$24.60



Water In Line Filter

Part No.	Type	Product Details (Inlet x Outlet)	Max PSI	Max GPM	Max F°	Each
23.0125	Aluminum	1/2" NPTF x 1/2" NPTM - 250 Micron	--	--	--	\$31.00
41.0618	Repair Kit	Aluminum Water Filter Repair Kit	--	--	--	\$13.30



Water Filter

Part No.	Type	Product Details (Inlet x Outlet)	Max PSI	Max GPM	Max F°	Each
23.0031	Plastic	1/2" NPTF x 1/2" NPTM - 177 Micron	145	14.5	--	\$32.75
23.0032	Plastic	3/4" NPTF x 3/4" NPTF - 177 Micron	145	14.5	--	\$32.75
41.0043	Replacement	Water Filter Screen	--	--	--	\$16.90
41.0044	Replacement	Water Filter Clear Bowl	--	--	--	\$15.10
41.0045	Replacement	Water Filter O-Ring	--	--	--	\$7.70



Fuel Filter

Part No.	Type	Product Details (Inlet x Outlet)	Max PSI	Max GPM	Max F°	Each
23.0023	Plastic	Hose Barb 6-8x2 - 120 Micron	--	--	--	\$8.20
23.0024	Plastic	Hose Barb 6-8x2 - 200 Micron	--	--	--	\$6.70
23.0025	Plastic	Hose Barb 5x2 - 300 Micron	--	--	--	\$5.70



Fuel Filter

Part No.	Type	Product Details (Inlet x Outlet)	Dim.	Max GPM	Max F°	Each
23.0028	Aluminum	1/4" NPTF x 1/4" NPTF	3" x 3"	--	--	\$37.40
23.0029	Aluminum	1/4" NPTF x 1/4" NPTF	3" x 3.5"	--	--	\$85.10
23.0030	Aluminum	1/4" NPTF x 1/4" NPTF w/ Drain Valve	3" x 3.5"	--	--	\$90.50
23.0095	Replacement	Fuel Filter Aluminum Housing 1/4"	--	--	--	\$6.95
23.0096	Replacement	Fuel Filter Seal (For 23.0099)	--	--	--	\$6.40
23.0097	Replacement	Fuel Filter Element 100 Micron	--	--	--	\$14.90
23.0098	Replacement	Fuel Filter Bowl	--	--	--	\$5.65
23.0099	Replacement	Fuel Filter Aluminum Screen 100 Micron	--	--	--	\$32.50
41.0041	Replacement	Fuel Filter Small Cartridge 1,300 Micron (For 23.0028)	--	--	--	\$25.25
41.0042	Replacement	Fuel Filter Large Cartridge 1,300 Micron (For 23.0029 & 23.0030)	--	--	--	\$41.75



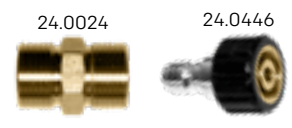

Garden Hose Adapters

Part No.	Size	Product Details (Inlet x Outlet)	Max PSI	Max GPM	Max F°	Each
24.0054		3/4" FGH x 3/8" NPTM - w/ Spring & Filter	--	--	--	\$7.45
24.0055		3/4" FGH x 1/2" NPTF	--	--	--	\$8.20
24.0056		3/4" FGH x 1/2" NPTM - w/ Spring & Filter	--	--	--	\$8.20
24.0057		3/4" FGH x 1/2" NPTM + 1/4" ByPass Port	--	--	--	\$21.80
24.0543		3/4" FGH x 3/8" NPTM + 1/4" ByPass Port	--	--	--	\$21.80

Garden Hose Quick Connects

Part No.	Type	Product Details (Inlet x Outlet)	Max PSI	Max GPM	Max F°	Each
24.0449	Brass	GH Coupler x 3/4" FGH	--	--	--	\$8.20
24.0450	Brass	GH Plug x 3/4" MGH	--	--	--	\$4.90
24.0631	Stainless	GH Coupler x EDPM 3/4" FGH	--	--	--	\$16.90
24.5002	Stainless	GH Plug 3/4" MGH	--	--	--	\$12.00

Garden Hose Washers

Part No.	Type	Product Details (Inlet x Outlet)	Max PSI	Max GPM	Max F°	Each
24.0094		w/ Filter	--	--	--	\$1.05
24.0095		w/o Filter	--	--	--	\$0.50
39.5001	(25 Pack)	Replacement EDPM GH Coupler Seal				\$18.25

Twist Seal Couplers

Part No.	Size	Product Details (Inlet x Outlet)	Max PSI	Max GPM	Max F°	Each
24.0085	14 mm	M22 x1.5 F x 1/4" NPTF	4,000	--	--	\$8.45
24.0086	14 mm	M22 x1.5 M x 1/4" NPTM	4,000	--	--	\$8.45
24.0087	14 mm	M22 x1.5 F x 3/8" NPTF	4,000	--	--	\$8.45
24.0088	14 mm	M22 x1.5 M x 3/8" NPTM	4,000	--	--	\$8.45

Twist Seal Plugs

Part No.	Size	Product Details (Inlet x Outlet)	Max PSI	Max GPM	Max F°	Each
24.0090	14 mm	M22 x1.5 F x 1/4" NPTF	4,000	--	--	\$4.90
24.0091	14 mm	M22 x1.5 M x 1/4" NPTM	4,000	--	--	\$4.90
24.0092	14 mm	M22 x1.5 F x 3/8" NPTF	4,000	--	--	\$4.90
24.0093	14 mm	M22 x1.5 M x 3/8" NPTM	4,000	--	--	\$4.90

Screw Adapters

Part No.	Size	Product Details (Inlet x Outlet)	Max PSI	Max GPM	Max F°	Each
24.0024	14 mm	M22M x M22M Twist Plug	4,000	--	--	\$5.65
24.0446	14 mm	M22 F Twist Coupler X 3/8" QC Plug	4,000	--	--	\$10.00
24.0447	14 mm	3/8" QC x M22M	4,000	--	--	\$12.10
24.0448	14 mm	3/8" QC x M22F Twist Coupler	4,000	--	--	\$15.70
24.0456	14 mm	M22 x 1.5 F x M22 x 1.5 F Coupler	4,000	--	--	\$11.50
24.0481	14 mm x 15 mm	M22M 14 mm x M22M 15 mm Twist Plug	4,000	--	--	\$4.65

Couplers

Part No.	Type	Product Details (Inlet x Outlet)	Max PSI	Max GPM	Max F°	Each
24.0067	Brass	1/4" FPT	5,500	--	--	\$8.20
24.0068	Brass	1/4" MPT	5,500	--	--	\$8.20
24.0069	Brass	3/8" FPT	4,200	--	--	\$10.00
24.0070	Brass	3/8" MPT	4,200	--	--	\$10.00
24.0071	Brass	1/2" FPT	3,600	--	--	\$17.70
24.0072	Brass	1/2" MPT	3,600	--	--	\$17.70
24.0590	Brass Insulated	1/4" FPT	5,500	--	--	\$8.45
24.0591	Brass Insulated	1/4" MPT	5,500	--	--	\$8.45
24.0592	Brass Insulated	3/8" FPT	4,200	--	--	\$10.75
24.0593	Brass Insulated	3/8" MPT	4,200	--	--	\$10.75
24.0061	Stainless	1/4" FPT	7,500	--	--	\$11.50
24.0062	Stainless	1/4" MPT	7,500	--	--	\$11.50
24.0063	Stainless	3/8" FPT	6,300	--	--	\$16.90
24.0064	Stainless	3/8" MPT	6,300	--	--	\$16.90
24.0065	Stainless	1/2" FPT	3,600	--	--	\$22.30
24.0066	Stainless	1/2" MPT	3,600	--	--	\$22.30
24.0638	Stainless Locking	3/8" FPT w/ Locking Collar	6,300	--	--	\$43.00
24.0639	Stainless Locking	3/8" MPT w/ Locking Collar	6,300	--	--	\$43.00
24.0623	Stainless Locking	1/2" FPT w/ Locking Collar	3,600	--	--	\$47.50
24.0637	Stainless Locking	1/2" MPT w/ Locking Collar	3,600	--	--	\$47.50
24.5001	Pivoting QC Nozzle Holder	1/4" QC Plug x 1/4" QC Coupler	4,500	--	--	\$38.28



Plugs

Part No.	Type	Product Details (Inlet x Outlet)	Max PSI	Max GPM	Max F°	Each
24.0073	Zinc Plated Steel	1/4" FPT	5,000	--	--	\$1.80
24.0074	Zinc Plated Steel	1/4" MPT	5,000	--	--	\$1.80
24.0075	Zinc Plated Steel	3/8" FPT	4,200	--	--	\$2.05
24.0076	Zinc Plated Steel	3/8" MPT	4,200	--	--	\$2.05
24.0077	Zinc Plated Steel	1/2" FPT	3,600	--	--	\$3.10
24.0078	Zinc Plated Steel	1/2" MPT	3,600	--	--	\$3.10
24.0079	Stainless	1/4" FPT	5,000	--	--	\$4.60
24.0080	Stainless	1/4" MPT	5,000	--	--	\$4.60
24.0081	Stainless	3/8" FPT	4,200	--	--	\$6.40
24.0082	Stainless	3/8" MPT	4,200	--	--	\$6.40
24.0083	Stainless	1/2" FPT	3,600	--	--	\$8.70
24.0084	Stainless	1/2" MPT	3,600	--	--	\$8.70

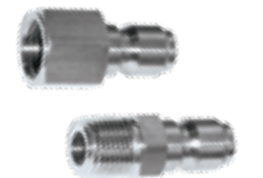



90° Swivels

Part No.	Type	Product Details (Inlet x Outlet)	Max PSI	Max GPM	Max F°	Each
26.0005	Nickel/Brass Stainless Stem	1/4" NPTM x 1/4" NPTF	4,100	10.5	250°	\$156.00
26.0006	Nickel/Brass Stainless Stem	3/8" NPTM x 1/4" NPTF	4,100	10.5	250°	\$156.00
26.0007	Nickel/Brass Stainless Stem	3/8" NPTM x 3/8" NPTF	4,100	10.5	250°	\$156.00
26.0008	Nickel/Brass Stainless Stem	1/4" NPTM x 3/8" NPTF	4,100	10.5	250°	\$156.00
41.0023	Repair Kit	90° Swivel Repair Kit For All Sizes	--	--	--	\$20.00



Swivel Coupling

Part No.	Type	Product Details (Inlet x Outlet)	Max PSI	Max GPM	Max F°	Each
22.0124	Brass	3/8" NPTF x 3/8" NPTM	3,600	8	250°	\$16.40

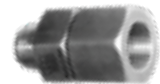

AG Swivels

Part No.	Type	Product Details (Inlet x Outlet)	Max PSI	Max GPM	Max F°	Each
22.0431	Brass	3/8" BSP x 3/8" BSPM - Straight	5,075	12	320°	\$41.00
22.0435	Stainless	3/8" BSP x 3/8" BSPM - Straight	5,800	12	320°	\$68.60



O-Rings

Part No.	Type	Product Details (Inlet x Outlet)	Max PSI	Max GPM	Max F°	Each
39.0024	Buna	(25 Pack) - 1/4" QC Coupler	--	--	--	\$8.20
39.0025	Buna	(100 Pack) - 1/4" QC Coupler	--	--	--	\$28.25
39.0026	Buna	(25 Pack) - 3/8" QC Coupler	--	--	--	\$9.00
39.0027	Buna	(100 Pack) - 3/8" QC Coupler	--	--	--	\$30.00
39.0028	Viton	(25 Pack) - 1/4" QC Coupler	--	--	--	\$24.10
39.0029	Viton	(100 Pack) - 1/4" QC Coupler	--	--	--	\$81.50
39.0030	Viton	(25 Pack) - 3/8" QC Coupler	--	--	--	\$26.50
39.0031	Viton	(100 Pack) - 3/8" QC Coupler	--	--	--	\$95.25
39.0130	Buna	(25 Pack) - M22 Twist 10*2 Connect Coupler O-Rings	--	--	--	\$11.25



Pressure Gauges

Part No.	Type	Product Details (Inlet x Outlet)	Max PSI	Max GPM	Max F°	Each
22.5006	Stainless	2.5" Diameter - 1/4" Bottom Mount	5,000	--	32°-212°	\$41.25
22.5007	Stainless	2.5" Diameter - 1/4" Bottom Mount	10,000	--	32°-212°	\$41.25
22.0239	Stainless	Back Mount Bracket	--	--	--	\$9.25
24.0100	Fitting Brass & Stainless	3/8" QC x 1/4" Port	--	--	--	\$16.40
24.0101	Fitting Stainless	3/8" QC x 1/4" Port	--	--	--	\$20.50
43.0038	Kit Brass & Stainless	2,300 PSI Gauge Kit	--	--	--	\$40.25
43.0039	Kit	6,000 PSI Pressure Test Gauge Kit	--	--	--	\$63.75

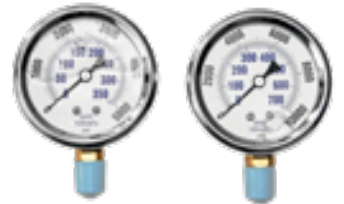

Pulsation Dampeners

Part No.	Type	Product Details (Inlet x Outlet)	Max PSI	Precharge	Max F°	Each
22.0096	0.1 Liter	3/8" NPTF	3,100	580	180°	\$256.00
22.0097	0.35 Liter	1/2" NPTF	3,100	580	180°	\$280.00



Axial Vibration Dampers

Part No.	Type	Product Details (Inlet x Outlet)	Max PSI	Max GPM	Max F°	Each
22.0362		M8 Male Threads - 29 mm Height	--	--	--	\$9.00
22.0363		M10 Male Threads - 35 mm Height	--	--	--	\$9.00



Frame Foot

Part No.	Type	Product Details (Inlet x Outlet)	Max PSI	Max GPM	Max F°	Each
22.0105	Rubber	2.5" Diameter - 1" Height	--	--	--	\$3.10



Nozzle Holder Grommet

Part No.	Type	Product Details (Inlet x Outlet)	Max PSI	Max GPM	Max F°	Each
22.0102	Rubber		--	--	--	\$0.50





Threadlock

Part No.	Size	Product Details (Inlet x Outlet)	Max PSI	Max GPM	Max F°	Each
22.0335	10ml	Medium 54-03	--	--	--	\$21.40
22.0336	10ml	Strong 83-54	--	--	--	\$21.40
22.0337	50 ml	Medium 54-03	--	--	--	\$77.10
22.0338	50 ml	Strong 83-54	--	--	--	\$77.10
22.0094	250 ml	Medium 54-03	--	--	--	\$168.50
22.0095	250 ml	Strong 83-54	--	--	--	\$168.50



Teflon Tape

Part No.	Type	Product Details (Inlet x Outlet)	Max PSI	Max GPM	Max F°	Each
22.0290		1/2" x 520" Roll - 0.10 Thickness	--	--	--	\$2.05



TS200 Rotating Brush

Part No.	Size	Type Details (Inlet x Outlet)	Max PSI	Max GPM	Max F°	Each
26.0009	6.5"	1/4" MPT - White Nylon Bristles 3 mm Nozzle	435	8	140°	\$86.75
26.0010	6.5"	1/4" MPT - Horse Hair Bristles 3 mm Nozzle	435	8	140°	\$103.50



Lance Brackets

Part No.	Type	Type Details (Inlet x Outlet)	Max PSI	Max GPM	Max F°	Each
22.0092	Plastic	MT3 Lance Brackets	--	--	--	\$5.90
22.0093	Plastic	MT2 Lance Brackets	--	--	--	\$5.90

10" Tires

Part No.	Size/Type	Product Details (Inlet x Outlet)	PSI	Size	Each
22.0083	10" Foam	Rubber Wheel w/ 3/4" Metal Bearing	--	2.875" x 10"	\$50.25
22.0084	10" Foam	Rubber Wheel w/ 5/8" Metal Bearing	--	2.875" x 10"	\$46.50
22.0265	10" Foam	Rubber Wheel w/ 3/4" Nylon Bushing	--	2.875" x 10"	\$45.25
22.0266	10" Foam	Rubber Wheel w/ 5/8" Nylon Bushing	--	2.875" x 10"	\$45.25
22.0264	10" Foam	Rubber Wheel w/o Bearing or Bushing	--	2.875" x 10"	\$44.00
22.0276	10" Tube	Rubber Wheel w/ 3/4" Metal Bearing	30	2.875" x 10"	\$30.25
22.0277	10" Tube	Rubber Wheel w/ 5/8" Metal Bearing	30	2.875" x 10"	\$30.25
22.0107	10" Tube	Rubber Wheel w/ 3/4" Nylon Bushing	30	2.875" x 10"	\$29.50
22.0108	10" Tube	Rubber Wheel w/ 5/8" Nylon Bushing	30	2.875" x 10"	\$29.50
22.0275	10" Tube	Rubber Wheel w/o Bearing or Bushing	30	2.875" x 10"	\$26.50



Tire Replacements

Part No.	Size/Type	Product Details (Inlet x Outlet)	PSI	Size	Each
22.0085	Replacement	3/4" Nylon Bushing	--	--	\$1.55
22.0086	Replacement	5/8" Nylon Bushing	--	--	\$1.55
22.0087	Replacement	3/4" Ball Bearing	--	--	\$2.55
22.0088	Replacement	5/8" Ball Bearing	--	--	\$2.55



PORTABLE HEATERS TERMS AND CONDITIONS

Terms and Conditions of Sales Order / Confirmation ("Agreement")

- 1. Payment.** Net 30 days on the total balance as detailed on the initial invoice. A service charge of 1.5% per month may be assessed on invoiced over 30 days.
- 2. Shipping.** Freight will be pre-paid by Veloci Performance™ Products ("Veloci") for all purchase orders of two machines or more. In the case of shipping one machine, Veloci Performance Products will pre-pay and add to the total of the invoice. Shipping discrepancies must be submitted within 48 hours of receipt of goods.
- 3. Pricing.** Veloci Performance Products reserves the right to change discounts and/or prices without notice. Trade discounts are based upon unit and dollar volume and are inclusive of warranty allowance. A surcharge may be added to individual orders in response to foreign currency exchange rate fluctuations. Pricing details include: (a) Price list effective January 1, 2018 - Subject to change without notice; (b) All prices F.O.B. Savage, Minnesota; (c) The price in effect at time of shipment will apply; (d) Pricing discrepancies must be filed within 30 days of invoice
- 4. Minimum Order.** \$30.01 minimum required for all orders. A \$3.50 minimum order fee may be applied to orders below \$30.01.
- 5. Returns.** All transportation costs for the return of the damaged equipment or components will be the responsibility of the Purchaser. If defective, Veloci will repair or replace the defective part or equipment and return the item freight pre-paid. If the item is not defective or operating normally, the item will be returned freight collect. Returns must follow the following procedures: (a) Returns for credit must be received within 30 days of shipment and pre-approved by Veloci; (b) All returns must be sent freight paid; (c) A return authorization number and invoice copy must accompany all returns; and (d) Please note that a 20% restocking charge may be assessed.
- 6. LIMITED WARRANTY: VELOCI WARRANTS TO THE ORIGINAL PURCHASER OF ITS PRODUCTS ("PURCHASER") THAT SUCH PRODUCTS WILL BE FREE FROM MATERIAL AND WORKMANSHIP DEFECTS UNDER NORMAL USE FOR THE PERIOD OF ONE YEAR FOR ALL PRODUCTS. "NORMAL USE" DOES NOT INCLUDE USE IN EXCESS OF RECOMMENDED MAXIMUM SPEEDS, FLOWS, PRESSURES, VACUUMS AND TEMPERATURES, OR USE REQUIRING HANDLING OF FLUIDS NOT COMPATIBLE WITH COMPONENT MATERIALS AS NOTED IN THE VELOCI CATALOG, TECHNICAL LITERATURE, AND INSTRUCTIONS. THIS WARRANTY DOES NOT COVER FREIGHT DAMAGE, FREEZING DAMAGE, NORMAL WEAR AND TEAR, OR DAMAGE CAUSED BY MISAPPLICATION, FAULT, NEGLIGENCE, ALTERATIONS, OR REPAIR THAT AFFECTS THE PERFORMANCE OR RELIABILITY OF THE PRODUCT. FAILURE TO PERFORM NORMAL AND ROUTINE MAINTENANCE ON THE HEATER, DAMAGE RELATED TO INSECTS, BIRDS, OR ANIMALS OF ANY KIND AND DAMAGE DUE TO WEATHER CONDITIONS ARE NOT COVERED. THIS WARRANTY DOES NOT COVER WEAR ITEMS SUCH AS FILTERS, VANES NOZZLES, AND ROTORS. THIS WARRANTY DOES NOT INCLUDE DAMAGE TO THE FINISH, SUCH AS SCRATCHES, DENTS, DISCOLORATION, RUST OR OTHER WEATHER DAMAGE AFTER PURCHASE.**
- 7. DISCLAIMER: EXCEPT FOR THE WARRANTY SET FORTH ABOVE, VELOCI MAKES NO WARRANTY WHATSOEVER WITH RESPECT TO THE PRODUCT, INCLUDING ANY WARRANTY OF MERCHANTABILITY OR WARRANTY OF FITNESS FOR A PARTICULAR PURPOSE; WHETHER EXPRESS OR IMPLIED BY LAW, COURSE OF DEALING, COURSE OF PERFORMANCE, USAGE OF TRADE OR OTHERWISE.**
- 8. EXCLUSIVE REMEDY: PURCHASER'S SOLE AND EXCLUSIVE REMEDY AND VELOCI'S ENTIRE LIABILITY FOR ANY BREACH OF THE LIMITED WARRANTY SET FORTH ABOVE SHALL BE TO REPAIR OR REPLACE SUCH DEFECTIVE PRODUCT. ANY DEFECTIVE PRODUCT MUST BE RETURNED TO VELOCI IN ACCORDANCE WITH THE PROCEDURES SET FORTH UNDER "RETURNS". PROOF OF PURCHASE MUST BE PROVIDED AT THE TIME WARRANTY SERVICE IS REQUESTED. THEREFORE, PURCHASER SHOULD KEEP THE SALES SLIP OR INVOICE FROM THE ORIGINAL PURCHASER.**
- 9. LIMITATION OF LIABILITY: IN NO EVENT SHALL VELOCI BE LIABLE FOR ANY CONSEQUENTIAL, INDIRECT, INCIDENTAL, SPECIAL, EXEMPLARY, PUNITIVE, OR ENHANCED DAMAGES, LOST PROFITS OR REVENUES OR DIMINUTION IN VALUE, ARISING OUT OF, OR RELATING TO, AND/OR IN CONNECTION WITH ANY BREACH OF THIS AGREEMENT, REGARDLESS OF (A) WHETHER SUCH DAMAGES WERE FORESEEABLE, (B) WHETHER OR NOT VELOCI WAS ADVISED OF THE POSSIBILITY OF SUCH DAMAGES, (C) THE LEGAL OR EQUITABLE THEORY (CONTRACT, TORT OR OTHERWISE) UPON WHICH THE CLAIM IS BASED, AND (D) THE FAILURE OF ANY AGREED OR OTHER REMEDY OF ITS ESSENTIAL PURPOSE. FOR THE PURPOSE OF THIS SECTION "CONSEQUENTIAL DAMAGE" SHALL INCLUDE, BUT NOT BE LIMITED TO, LOSS AND/OR DEFERRAL OF PRODUCTION, LOSS OF PRODUCT, LOSS OF USE, LOSS OF REVENUE, PROFIT OR ANTICIPATED PROFIT, LOSS OF CONTRACT AND/OR BUSINESS OPPORTUNITY. IN NO EVENT SHALL VELOCI'S AGGREGATE LIABILITY ARISING OUT OF OR RELATED TO THIS AGREEMENT, WHETHER ARISING OUT OF OR RELATED TO BREACH OF CONTRACT, TORT (INCLUDING NEGLIGENCE) OR OTHERWISE, EXCEED THE TOTAL OF THE AMOUNTS PAID TO VELOCI FOR THE PRODUCT SOLD HEREUNDER.**
- 10. Indemnification.** Purchaser shall indemnify, defend and hold harmless VELOCI and its officers, directors, employees, agents, affiliates, successors and permitted assigns (collectively, "Indemnified Party") against any and all losses, damages, liabilities, deficiencies, claims, actions, judgments, settlements, interest, awards, penalties, fines, costs, or expenses of whatever kind, including reasonable attorneys' fees, fees and the costs of enforcing any right to indemnification under this Agreement and the cost of pursuing any insurance providers, incurred by Indemnified Party, relating to/arising out of or resulting from any claim of a third party or VELOCI arising out of or occurring in connection with the products sold pursuant to this Agreement or Purchaser's negligence, willful misconduct or breach of this Agreement. Purchaser shall not enter into any settlement without VELOCI's or Indemnified Party's prior written consent.
- 11. Choice of Law/Forum.** This Agreement and all matters arising out of or relating to this Agreement, are governed by, and construed and enforced in accordance with, the laws of the State of Minnesota, without regard to the conflict of interest laws provisions. Each party irrevocably and unconditionally agrees that it will not commence any action, litigation, or proceeding of any kind whatsoever against any other party in any way arising from or relating to this Agreement and all contemplated transactions, including, but not limited to, contract, equity, tort, fraud, and statutory claims, in any forum other than the competent courts in the State of Minnesota.

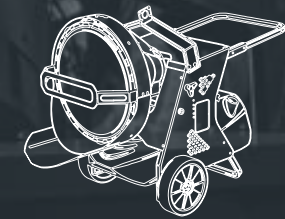

PORTABLE HEATERS

Whether you're curing concrete, warming equipment or heating spaces, you'll work faster and smarter with Veloci portable heaters. Our versatile, Italian-engineered radiant and forced-air heaters are built for performance, allowing you to get more done in a day.



Flame115 Made In Italy

› Radiant Heaters

Are characterized by the absence of moving air, the flame generated by the burner heats the front plate which reaches high temperatures and projects heat outward. Our infrared diesel heaters also have an embedded burner with dedicated fan for a cleaner combustion. This helps to burn and stop all combustion residues, guaranteeing a clean combustion and 99.9% efficiency. Their versatile use allows them to heat objects and spaces more efficiently than traditional heat sources.

› The Innovation Of The Flame115 Infrared Heater

Lies in the elimination of the refractory material cone that surrounds the conical combustion chamber that's typical of other competitor's units. Our heater features a metallic forced air insulation pocket between the combustion chamber and the external protection cone. The cooling air is blown through the pocket by the burner fan. This innovative technology over comes the well-known problem of the fragility and brittleness of the ceramic cone.

Flame115 Radiant

Part No.	Mfg. Part No.	Product Details
48.7019	06VA203	Infrared Portable Heater

Flame115 Specifications

	Measurement	Rating
Max Power	BTU\H	115,160
Fuel Consumption	US GAL\H	0.85
Power Supply	V, PH, HZ	120,1,60
Fan Motor Power	HP (RPM)	1/4 (3,300)
Current Rating	AMPS	2.15
Tank Capacity	US GAL	11.35
Run Time	HOUR	13.4
Pallet	QTY	1
20' Container	QTY	84
40' and 40' HC Container	QTY	180

Flame115 Accessories

Part No.	Mfg. Part No.	Product Details
48.7101	02AC582	20°F/120°F Thermostat w/ 30' Cable
48.7102	02AC583	Fuel Level Gauge
48.7272	--	Flame115 Annual Maintenance Kit

- › Approved For Construction & Agriculture
- › CSA Approved › Directional Cone Locking Mechanism
- › Low Noise Level › Built-In Oil Burner With Gear Pump
- › Electronic Flame Control Unit With Metal Casing
- › Screw-on Fuel Gauge › AISI 309 L Stainless Steel Cone
- › Shockproof Polythene Fuel Tank › Fuel Tank Drain Plug
- › Automatic Post-Ventilation Cooling Cycle › Only 92 lbs.
- › Extendable Sliding Floor Shield › Remote Thermostat Plug
- › Patented Triple Cone Design › 8" Reinforced Plastic Wheels



Fire155 Made In Italy

› Radiant Heaters

Are characterized by the absence of moving air, the flame generated by the burner heats the front plate which reaches high temperatures and projects heat outward. Our infrared diesel heaters also have an embedded burner with dedicated fan for a cleaner combustion. This helps to burn and stop all combustion residues, guaranteeing a clean combustion and 99.9% efficiency. Their versatile use allows them to heat objects and spaces more efficiently than traditional heat sources.

› The Innovation Of The Fire155 Infrared Heater

Lies in the elimination of the refractory material cone that surrounds the conical combustion chamber that's typical of other competitor's units. Our heater features a metallic forced air insulation pocket between the combustion chamber and the external protection cone. The cooling air is blown through the pocket by the burner fan. This innovative technology over comes the well-known problem of the fragility and brittleness of the ceramic cone.



- › Approved For Construction & Agriculture
- › Built-In Oil Burner With Gear Pump
- › Electronic Flame Control Unit With Metal Casing
- › Low Noise Level › CSA Approved
- › Automatic Post-Ventilation Cooling Cycle
- › Patented Triple Cone Design › Fuel Lines Wire-Mesh Protected
- › Shockproof Polythene Fuel Tank › Thermostat Plug
- › AISI 430 Stainless Steel Combustion Chamber
- › Screw-On Fuel Gauge › Fuel Tank Drain Plug
- › Directional Cone Locking Mechanism › Single Point Lift Bail
- › 12" Reinforced Plastic Wheels › Floor Protection Sliding Shield

Fire155 Radiant

Part No.	Mfg. Part No.	Product Details
48.7001	06VA201	Infrared Portable Heater

Fire155 Specifications

	Measurement	Rating
Max Power	BTU\H	154,237
Fuel Consumption	US GAL\H	1.11
Power Supply	V, PH, HZ	120, 1, 60
Fan Motor Power	HP (RPM)	1/4 (3,300)
Current Rating	AMPS	4.1
Tank Capacity	US GAL	17.2
Run Time	HOUR	16
Pallet	QTY	1
20' Container	QTY	26
40' and 40' HC Container	QTY	56

Fire155 Accessories

Part No.	Mfg. Part No.	Product Details
48.7101	02AC582	20°F/120°F Thermostat w/ 30' Cable & 90° Plug
48.7102	02AC583	Fuel Level Gauge
48.7103	02AC513	Pre-Heated Oil Filter
48.7273	--	Fire155 Annual Maintenance Kit





Blaze Made In Italy

› **Blaze**
 Diesel indirect-fired portable heaters with embedded burner with combustion air obtained from the main ventilation fan. The Blaze heaters feature a heat exchanger that contains the flame and expels fumes throughout a chimney connected to the outside. Being indirect-fired, they can be operated indoors and can also be ducted.

› **Four Pass Heat Exchanger Technology**
 The new fourpass heat exchanger technology allows exhaust gases to increase heat exchange with the cooling air and obtain maximum thermal efficiency. Our heaters are the most efficient in the industry.



- › Approved For Construction › Overheating Thermostat
- › Electric Control Panel › Combustion Air Pressure Switch
- › Controllable By The Thermostat, Humidistat Or Timer
- › Electronic Flame Control Unit › Fuel Tank Drain Plug
- › Hydrocarbon-Resistant Fuel Lines › 10" Pneumatic Wheels
- › Automatic Post-Ventilation Cooling Cycle

Blaze Indirect Series

Part No.	Mfg. Part No.	Product Details
48.7002	02EC202	Blaze100
48.7003	02EC203	Blaze200 w/ Pre-Heat Filter
48.7004	02EC204	Blaze300 w/ Pre-Heat Filter

Blaze Accessories

Part No.	Mfg. Part No.	Product Details
48.7101	02AC582	20°/120°F Heavy Duty Thermostat w/ 30 ft. Cable & 90° Plug
48.7103	02AC513	Blaze100 Pre-Heated Oil Filter
48.7105	02AC508	Blaze200 & 300 Fuel Level Gauge
48.7106	02AC556	Fuel Tank Filter
48.7107	02AC511	4 Lifting Brackets
48.7109	02AC501	Blaze100 12" One Way Duct Adapter
48.7110	02AC502	Blaze200 14" One Way Duct Adapter
48.7111	02AC503	Blaze300 16" One Way Duct Adapter
48.7112	02AC546	Blaze200 12" Two Way Duct Adapter
48.7113	02AC505	Blaze300 12" Two Way Duct Adapter
48.7115	02AC512	External Fuel Tank Connection Kit
48.7116	02AC632	External Fuel Tank Connection Kit w/ Deaerator (Tiger Loop)
48.7118	02AC562	12" x 20' Flexible Air Duct
48.7119	02AC563	14" x 20' Flexible Air Duct
48.7120	02AC564	16" x 20' Flexible Air Duct
48.7174	02AC507	Blaze100 Fuel Level Gauge
48.7274	--	Blaze100 Annual Maintenance Kit
48.7275	--	Blaze200 Annual Maintenance Kit
48.7276	--	Blaze300 Annual Maintenance Kit



Blaze Specifications

		Blaze100	Blaze200	Blaze300
	Measurement	Rating	Rating	Rating
Heat Input	BTU/H	112,141	204,873	293,982
Heat Output	BTU/H	94,759	183,362	258,704
Fuel Consumption	US GAL/H	0.81	1.48	2.17
Heated Airflow	CFM	1,020	1,530	2,530
Temperature Rise (@64°F)	°F	95	136	126
Power Supply	V, PH, HZ	120, 1, 60	120, 1, 60	120, 1, 60
Fan Motor Power	HP (RPM)	1/4 (3,300)	5/8 (3,300)	1 (1,700)
Current Rating	AMPS	4.05	7.65	11.80
Max Length Flex. Duct (1-Way)	FT	25	50	75
Max Length Flex. Duct (2-Way)	FT	--	25	35
Flue Size	IN	6	6	6
Tank Capacity	US GAL	11	17.2	27.7
Run Time	HOURLY	14	14	13
Pallet	QTY	6	1	1
20' Container	QTY	54	38	24
40' Container	QTY	132	82	52
40' HC Container	QTY	132	82	52

Firestorm Made In Italy

› **Firestorm400**
 Heavy duty diesel indirect-fired portable heaters with embedded burner and dedicated fan for combustion air. The Firestorm heaters feature a heat exchanger that contains the flame and expels fumes throughout a chimney connected to the outside. Being indirect-fired, they can be operated indoors and can also be ducted.

› **Four Pass Heat Exchanger Technology**
 The new fourpass heat exchanger technology allows exhaust gases to increase heat exchange with the cooling air and obtain maximum thermal efficiency. Our heaters are the most efficient in the industry.



- › Approved For Construction & Agriculture
- › Electric Control Panel › Combustion Air Pressure Switch
- › Can Be Controlled By The Thermostat, Humidistat Or Timer
- › Electronic Flame Control Unit › Screw On Fuel Tank Cap
- › Anti-shock frame with foldable handle
- › Automatic Post-Ventilation Cooling Cycle
- › Built-In Oil Burner With Gear Pump
- › Hydrocarbon-Resistant Fuel Lines
- › Fuel Tank Drain Plug › 16" Pneumatic Wheels

Firestorm400 HC Indirect

Part No.	Mfg. Part No.	Product Details
48.7009	02EC260-MT	Firestorm400 HC

Firestorm400 HC Accessories

Part No.	Mfg. Part No.	Product Details
48.7101	02AC582	20°/120°F Heavy Duty Thermostat w/ 30 ft. Cable & 90° Plug
48.7104	02AC597	Single Fuel Line Kit
48.7107	02AC511	4 Lifting Brackets
48.7116	02AC632	External Fuel Tank Connection Kit w/ Deaerator (Tiger Loop)
48.7118	02AC562	12" x 20' Flexible Air Duct (Three Way)
48.7120	02AC564	16" x 20' Flexible Air Duct (Two Way)
48.7177	02AC213	20" x 20' Air Inlet Duct
48.7179	02AC504	20" One Way Duct Adapter
48.7180	02AC506	16" x 16" Two Way Duct Adapter
48.7184	02AC558	20" Air Inlet Duct Adapter
48.7185	02AC564	16" x 20' Flexible Air Duct
48.7186	02AC566	20" x 20' Flexible Air Duct (One Way)
48.7198	02AC579	12" x 12" x 12" Three Way Duct Adapter
TBD	02AC510	Fuel Level Gauge

Firestorm400 HC Specifications

	Measurement	Rating
Heat Input 2nd Stage	BTU/H	411,905
Heat Input 1st Stage	BTU/H	272,189
Heat Output 2nd Stage	BTU/H	354,239
Heat Output 1st Stage	BTU/H	231,360
Fuel Consumption 2nd Stage	US Gal/H	2.97
Fuel Consumption 1st Stage	US Gal/H	1.96
Airflow	CFM	3,250
Temp. Rise (@64 F) 2nd Stage	F	132
Temp. Rise (@64 F) 1st Stage	F	108
Power Supply	V,PH,HZ	120,1,60
Fan Motor Power	HP (RPM)	1 (1,700)
Burner Motor Power	HP (RPM)	1/4 (3,300)
Current Rating	AMPS	13
Max Length Duct 1-Way/2-Way	Ft	100/60
Max Length Air Inlet Duct	Ft	30
Max Length Fresh Air Intake	Ft	15
Flue Size	In	6
Tank Capacity	US Gal	57
Run Time 2nd Stage - 1st Stage	Hr	29 - 19
Pallet	Qty	1
Container 20'/40'/40'HC	Qty	7/16/31

Flame115 Replacements

Part No.	Mfg. Part No.	Product Details
48.7129	E10698	Pump - Motor Coupling
48.7131	I40339	450 mm Micropipe (Pressurized Supply)
48.7135	E40125	Brahma TGRD Control Box
48.7136	E10248	Ignition Electrode
48.7158	E50328	Photo Eye
48.7168	T20118	Danfoss BFA01 Solenoid Spool
48.7169	T20117	Danfoss Solenoid Valve
48.7188	M20204	Axle Clip
48.7208	--	M5 mm x 16 mm Heat Shield Wing Knob
48.7212	C10714	M8x20 Tilt Adjustment Knob
48.7213	I40347	360 mm x 1/4" F Upper Fuel Line
48.7214	C30729	Fuel Line Clip
48.7215	I30414	Fuel Filter
48.7216	I40327	Lower Fuel Line
48.7217	I40348	Fuel Return Line
48.7218	C10513-N	Wheel Axle Cover
48.7219	T20375	Delavan 80°W - 0.65 GPH Fuel Nozzle
48.7220	G02089	Ignition Electrode Cable
48.7221	E10769	100 W x 120 V x 60 Hz Motor & Capacitor
48.7222	E10769-1	Capacitor
48.7223	T20448	Danfoss BFA01 Fuel Pump

Blaze Replacements

Part No.	Mfg. Part No.	Product Details
48.7135	E40125	Blaze100 Brahma TGRD Control Box
48.7136	E10248	Blaze100 Ignition Electrode
48.7137	T20361	Blaze100 0.55 GPH - 80°W Nozzle
48.7138	T20429-1	Blaze100 Danfoss BFA01 Pump
48.7139	T20355	Blaze200 1.10 GPH - 80°W Nozzle
48.7140	T20410-1	Blaze200 Danfoss BFP Pump
48.7141	E11249	Blaze300 Capacitor 80 µF
48.7142	E10514	Blaze300 K2 Coupling
48.7143	E10704-110	Blaze300 750 W Motor w/ Capacitor
48.7144	T20411-1	Blaze300 Danfoss BFPC21 Pump
48.7149	E11233	Blaze100 Capacitor 20 µF
48.7150	E11230	Blaze200 Capacitor 40 µF
48.7151	E40124	Blaze200 & 300 120 V Brahma TGRD Control Box
48.7152	E10513	Blaze100 & 200 K1 Coupling
48.7153	E10215	Blaze200 & 300 Electrode
48.7154	T20242	Blaze100, 200 & 300 Preheat Filter Cartridge
48.7155	T20206	Blaze100 Filter Cartridge
48.7156	E10313	Blaze200 & 300 6 x 30 20 A Fuse

Fire155 Replacements

Part No.	Mfg. Part No.	Product Details
48.7103	O2AC513	Pre-Heated Oil Filter
48.7104	O2AC597	Single Fuel Line Kit
48.7129	E10698	Pump - Motor Coupling
48.7130	G02076	1,000 mm Ignitor Cable Connect
48.7131	I40339	450 mm Micropipe (Pressurized Supply)
48.7132	T20363	80° W - 0.85 GPH Nozzle
48.7133	T20450	Danfoss BFP21 R3 Pump
48.7134	G11018	Turbo Disc
48.7149	E11233	20 µF Capacitor
48.7151	E40124	Brahma TGRD 91 Control Box
48.7153	E10215	Ignition Electrode
48.7155	T20206	Filter Cartridge
48.7158	E50328	Photo Eye
48.7160	E10677-110	200 W Motor w/ Capacitor
48.7162	T20201	1/4" Complete Filter Assembly
48.7165	T20234	Oil Filter O-Ring Kit
48.7168	T20118	Danfoss BFA 01 Solenoid Spool
48.7169	T20117	Danfoss Solenoid Valve
48.7170	E10930	Brahma Transformer
48.7176	T20212	Oil Filter Housing
48.7188	M20204	Axle Clip
48.7208	--	M5 mm x 16 mm Heat Shield Wing Knob
48.7210	G06322	M8 x 25 Tilt Adjustment Knob
48.7218	C10513-N	Wheel Axle Cover

Blaze Replacements Cont.

Part No.	Mfg. Part No.	Product Details
48.7157	G02078	Blaze100, 200 & 300 90° Cable Connect
48.7158	E50328	Blaze100, 200 & 300 Photo Eye
48.7159	I40192	Blaze100, 200 & 300 Micropipe
48.7160	E10677-110	Blaze100 200 W Motor w/ Condenser
48.7161	E10678-110	Blaze200 450W Motor w/ Capacitor
48.7163	T20239	Blaze200 & 300 Pre-Heated Filter 1/4"
48.7164	T20241	Blaze200 & 300 O-Ring Kit for P.H. Filter
48.7165	T20234	Blaze100 O-Ring Kit for Filter
48.7166	E50440	Blaze100 200 & 300 Pressure Switch
48.7167	E11125	Blaze200 Relay Finder 65.31 AC
48.7171	G01077	Blaze100 200 & 300 Turbo Disc
48.7172	T20356	Blaze300 1.50 GPH - 80° W Nozzle
48.7192	O2AC285	Blaze SS Chimney Duct 150mm x 1 meter
48.7193	O2AC282	Blaze SS Chimney Cap 150mm

BTU/h Requirements

To determine the BTU/h needed to heat a given area, first, determine the total cubic feet of the area (length x width x height). Secondly, determine your desired temperature rise (your current room temperature is 50°F, your desired temperature is 70°F, your rise in temperature is 20°F). Lastly, where your cubic feet row intersects with your rise in temperature column, is your needed BTU/h to heat the area (see highlighted cells for reference).

Cubic Feet	RISE IN TEMPERATURE							
	10°F	20°F	30°F	40°F	50°F	60°F	70°F	80°F
4,000	5,320	10,640	15,960	21,280	26,600	31,920	37,240	42,560
8,000	10,640	21,280	31,920	42,560	53,200	63,840	74,480	85,120
12,000	15,960	31,920	47,880	63,840	79,800	95,760	111,720	127,680
16,000	21,280	42,650	63,840	85,120	106,400	127,680	148,960	170,240
20,000	26,600	53,200	79,800	106,400	133,000	159,600	186,200	212,800
24,000	31,920	63,840	95,760	127,680	159,600	191,520	223,440	255,360
28,000	37,240	74,480	111,720	148,960	186,200	223,440	260,680	297,920
32,000	42,560	85,120	127,680	170,240	212,800	255,360	297,920	340,480
36,000	47,880	95,760	143,640	191,520	239,400	287,280	335,160	383,040
40,000	53,200	106,400	159,600	212,800	266,000	319,200	372,400	425,600
44,000	58,520	117,040	175,560	234,080	292,600	351,120	409,640	468,160
48,000	63,840	127,680	191,520	255,360	319,200	383,040	446,880	510,720
52,000	69,160	138,320	207,480	276,640	345,800	414,960	484,120	553,720
56,000	74,480	148,960	223,440	297,920	372,400	446,880	521,360	595,840
60,000	79,800	159,600	239,400	319,200	399,000	478,800	558,600	638,400
64,000	85,120	170,240	255,360	340,480	425,600	510,720	595,840	680,960
68,000	90,440	180,880	271,320	361,760	452,200	542,640	633,080	723,520
72,000	95,760	191,520	287,280	383,040	478,800	574,560	670,320	766,080
76,000	101,080	202,160	303,240	404,320	505,400	606,480	707,560	808,640
80,000	106,400	212,800	319,200	425,600	532,000	638,400	744,800	851,200
84,000	111,720	223,440	335,160	446,880	558,600	670,320	782,040	893,760
88,000	117,040	234,080	351,120	468,160	582,200	702,240	819,280	936,320
92,000	122,360	244,720	367,080	489,440	611,800	734,160	856,520	978,880
96,000	127,680	255,360	383,040	510,720	638,400	766,080	893,760	1,021,440
100,000	133,000	266,000	399,000	532,000	665,000	798,000	931,000	1,064,000
104,000	138,320	276,640	414,960	553,280	691,600	829,920	968,240	1,106,560
108,000	143,640	287,280	430,920	574,560	718,200	861,840	1,005,480	1,149,120
112,000	148,960	297,920	446,880	595,840	744,800	893,760	1,042,720	1,191,680
116,000	154,280	308,560	462,840	617,120	771,400	925,680	1,079,960	1,234,240
120,000	159,600	319,200	478,880	638,400	798,000	957,600	1,117,200	1,276,800

The number of BTU/h may vary due to building configurations, material, and variables in weather.

ENGINE PARTS AND PUMP KITS TERMS AND CONDITIONS

Terms and Conditions of Sales Order / Confirmation ("Agreement")

- 1. Payment.** Standard terms are net 30 days from date of invoice for accounts with approved credit by VELOCI PERFORMANCETM PRODUCTS ("VELOCI"). A service charge of 1.5% per month may be assessed on invoiced over 30 days.
- 2. Shipping.** All freight is shipped freight collect. All other orders are shipped by United Parcel Service (UPS) unless otherwise specified. UPS charges are prepaid and added to the invoice. All shipping discrepancies must be submitted within 24 hours of receipt of products.
- 3. Pricing.** Veloci Performance Products reserves the right to change discounts and/or prices without notice. Trade discounts are based upon unit and dollar volume and are inclusive of warranty allowance. A surcharge may be added to individual orders in response to foreign currency exchange rate fluctuations. Pricing details include: (a) Price list effective January 1, 2018 - Subject to change without notice; (b) All prices F.O.B. Savage, Minnesota; (c) The price in effect at time of shipment will apply; and (d) Pricing discrepancies must be filed within 30 days of invoice
- 4. Minimum Order.** \$30.01 minimum required for all orders. A \$3.50 minimum order fee may be applied to orders below \$30.01.
- 5. Returns.** Returns must follow the following procedures: (a) Returns for credit must be received within 30 days of shipment and pre-approved by Veloci; (b) All returns must be sent freight paid; (c) A return authorization number and invoice copy must accompany all returns; and (d) Please note that a restocking charge may be assessed.
- 6. LIMITED WARRANTY: VELOCI WARRANTS TO THE ORIGINAL PURCHASER OF ITS PRODUCTS ("PURCHASER") THAT SUCH PRODUCTS WILL BE FREE FROM MATERIAL AND WORKMANSHIP DEFECTS UNDER NORMAL USE FOR THE PERIOD OF NINETY (90) DAYS FOR ALL PRODUCTS. "NORMAL USE" DOES NOT INCLUDE USE IN EXCESS OF RECOMMENDED MAXIMUM SPEEDS, FLOWS, PRESSURES, VACUUMS AND TEMPERATURES, OR USE REQUIRING HANDLING OF FLUIDS NOT COMPATIBLE WITH COMPONENT MATERIALS AS NOTED IN THE VELOCI CATALOG, TECHNICAL LITERATURE, AND INSTRUCTIONS. THIS WARRANTY DOES NOT COVER FREIGHT DAMAGE, FREEZING DAMAGE, NORMAL WEAR AND TEAR, OR DAMAGE CAUSED BY MISAPPLICATION, FAULT, NEGLIGENCE, ALTERATIONS, OR REPAIR THAT AFFECTS THE PERFORMANCE OR RELIABILITY OF THE PRODUCT.**
- 7. DISCLAIMER: EXCEPT FOR THE WARRANTY SET FORTH ABOVE, VELOCI MAKES NO WARRANTY WHATSOEVER WITH RESPECT TO THE PRODUCT, INCLUDING ANY WARRANTY OF MERCHANTABILITY OR WARRANTY OF FITNESS FOR A PARTICULAR PURPOSE; WHETHER EXPRESS OR IMPLIED BY LAW, COURSE OF DEALING, COURSE OF PERFORMANCE, USAGE OF TRADE OR OTHERWISE.**
- 8. EXCLUSIVE REMEDY: PURCHASER'S SOLE AND EXCLUSIVE REMEDY AND VELOCI'S ENTIRE LIABILITY FOR ANY BREACH OF THE LIMITED WARRANTY SET FORTH ABOVE SHALL BE TO REPAIR OR REPLACE SUCH DEFECTIVE PRODUCT. ANY DEFECTIVE PRODUCT MUST BE RETURNED TO VELOCI IN ACCORDANCE WITH THE PROCEDURES SET FORTH UNDER "RETURNS".**
- 9. LIMITATION OF LIABILITY: IN NO EVENT SHALL VELOCI BE LIABLE FOR ANY CONSEQUENTIAL, INDIRECT, INCIDENTAL, SPECIAL, EXEMPLARY, PUNITIVE, OR ENHANCED DAMAGES, LOST PROFITS OR REVENUES OR DIMINUTION IN VALUE, ARISING OUT OF, OR RELATING TO, AND/OR IN CONNECTION WITH ANY BREACH OF THIS AGREEMENT, REGARDLESS OF (A) WHETHER SUCH DAMAGES WERE FORESEEABLE, (B) WHETHER OR NOT VELOCI WAS ADVISED OF THE POSSIBILITY OF SUCH DAMAGES, (C) THE LEGAL OR EQUITABLE THEORY (CONTRACT, TORT OR OTHERWISE) UPON WHICH THE CLAIM IS BASED, AND (D) THE FAILURE OF ANY AGREED OR OTHER REMEDY OF ITS ESSENTIAL PURPOSE. FOR THE PURPOSE OF THIS SECTION "CONSEQUENTIAL DAMAGE" SHALL INCLUDE, BUT NOT BE LIMITED TO, LOSS AND/OR DEFERRAL OF PRODUCTION, LOSS OF PRODUCT, LOSS OF USE, LOSS OF REVENUE, PROFIT OR ANTICIPATED PROFIT, LOSS OF CONTRACT AND/OR BUSINESS OPPORTUNITY. IN NO EVENT SHALL VELOCI'S AGGREGATE LIABILITY ARISING OUT OF OR RELATED TO THIS AGREEMENT, WHETHER ARISING OUT OF OR RELATED TO BREACH OF CONTRACT, TORT (INCLUDING NEGLIGENCE) OR OTHERWISE, EXCEED THE TOTAL OF THE AMOUNTS PAID TO VELOCI FOR THE PRODUCT SOLD HEREUNDER.**
- 10. Indemnification.** Purchaser shall indemnify, defend and hold harmless VELOCI and its officers, directors, employees, agents, affiliates, successors and permitted assigns (collectively, "Indemnified Party") against any and all losses, damages, liabilities, deficiencies, claims, actions, judgments, settlements, interest, awards, penalties, fines, costs, or expenses of whatever kind, including reasonable attorneys' fees, fees and the costs of enforcing any right to indemnification under this Agreement and the cost of pursuing any insurance providers, incurred by Indemnified Party, relating to/arising out of or resulting from any claim of a third party or VELOCI arising out of or occurring in connection with the products sold pursuant to this Agreement or Purchaser's negligence, willful misconduct or breach of this Agreement. Purchaser shall not enter into any settlement without VELOCI's or Indemnified Party's prior written consent.
- 11. Choice of Law/Forum.** This Agreement and all matters arising out of or relating to this Agreement, are governed by, and construed and enforced in accordance with, the laws of the State of Minnesota, without regard to the conflict of interest laws provisions. Each party irrevocably and unconditionally agrees that it will not commence any action, litigation, or proceeding of any kind whatsoever against any other party in any way arising from or relating to this Agreement and all contemplated transactions, including, but not limited to, contract, equity, tort, fraud, and statutory claims, in any forum other than the competent courts in the State of Minnesota.

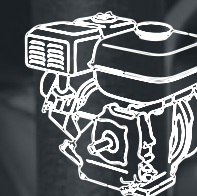

ENGINE PARTS

Don't just get your customer up and running, keep them up and running with MTM Hydro's replacement engine parts. These high quality, affordable replacement parts, fit on a variety of small engines and bring you to the next level in your service and repair.



Red Recoil Starter Assembly

Part No.	Product Details	Each
50.5001	Red Recoil Starter Assembly GX 120 - 160 - 200 w/Pawl	\$41.50
50.5002	Red Recoil Starter Assembly GX 240 - 270 (Pawl Not Included)	\$52.75
50.5003	Red Recoil Starter Assembly GX 340 - 390 (Pawl Not Included)	\$53.50
50.5036	Recoil Starter Ratchet Kit GX 120 - 160 - 200 - 240 - 270 - 340 - 390	\$ 5.75

Black Recoil Starter Assembly

Part No.	Product Details	Each
50.9142	Black Recoil Starter Assembly GX 120 - 160 - 200 w/Pawl	\$ 47.75
50.9140	Black Recoil Starter Assembly GX 240-270 (Pawl Not Included)	\$ 63.25
50.9141	Black Recoil Starter Assembly GX 340 - 390 (Pawl Not Included)	\$ 60.00

Recoil Starter Pulley

Part No.	Product Details	Each
50.5029	Recoil Starter Pulley GX 120 - 160 - 200	\$8.75
50.5030	Recoil Starter Pulley GX 240 - 270	\$9.25
50.5031	Recoil Starter Pulley GX 340 - 390	\$9.25

(6 Pack) Starter Spring

Part No.	Product Details	Each
50.5032	(6 Pack) Starter Spring GX 120 - 160 - 200	\$47.00
50.5033	(6 Pack) Starter Spring GX 240 - 270 - 340 - 390	\$56.50

Recoil Rope 55" And Starter Handle

Part No.	Product Details	Each
50.5034	#6 Recoil Rope 55" & Handle GX 240 - 270 - 340 - 390	\$13.50
50.5035	#5 Recoil Rope 55" & Handle GX 120 - 160 - 200	\$12.50

Carburetor Assembly

Part No.	Product Details	Each
50.5062	Carburetor Assembly GX 160	\$ 45.75
50.5063	Carburetor Assembly GX 200	\$ 45.25
50.5064	Carburetor Assembly GX 240	\$ 76.25
50.5065	Carburetor Assembly GX 270	\$ 76.75
50.5066	Carburetor Assembly GX 340	\$ 79.25
50.5067	Carburetor Assembly GX 390	\$ 78.75
50.5093	Carburetor Repair Kit GX 120	\$ 16.00
50.5094	Carburetor Repair Kit GX 160	\$ 15.50
50.5095	Carburetor Repair Kit GX 200	\$ 15.25
50.5096	Carburetor Repair Kit GX 270	\$ 17.25
50.5097	Carburetor Repair Kit GX 240	\$ 20.75
50.5098	Carburetor Repair Kit GX 340	\$ 17.25
50.5099	Carburetor Repair Kit GX 390	\$ 17.00



Float Chamber Set

Part No.	Product Details	Each
50.5100	Float Chamber Set GX 120 - 160 - 200	\$ 4.75
50.5101	Float Chamber Set GX 240 - 270 - 340 - 390	\$ 6.25
50.5102	Float Set GX 120 - 140 - 160 - 200	\$ 2.00
50.5103	Float Set GX 240 - 270 - 340 - 390	\$ 2.25



Choke Set

Part No.	Product Details	Each
50.5104	Choke Set GX 120 - 160 - 200	\$ 4.75
50.5105	Choke Set GX 240 - 270	\$ 4.75
50.5106	Choke Set GX 340	\$ 4.75
50.5107	Choke Set GX 390	\$ 4.75



Float Valve Set

Part No.	Product Details	Each
50.5108	Float Valve Set GX 120 - 200	\$ 2.25
50.5109	Float Valve Set GX 240 - 390	\$ 2.50



Air Filter

Part No.	Product Details	Each
50.5135	Air Filter GX 140 - 160 - 200	\$ 11.50
50.5136	Air Filter GX 240 - 270	\$ 17.75
50.5137	Air Filter GX 340 - 390	\$ 19.25
50.5138	Air Filter GX 610KS - GX 620K1 - GX 670	\$ 48.00



(6 Pack) Foam Pre Filter

Part No.	Product Details	Each
50.5139	(6 Pack) Foam Pre Filter GX 160 - 200	\$ 20.00
50.5140	(6 Pack) Foam Pre Filter GX 240 - 270	\$ 25.00
50.5141	(6 Pack) Foam Pre Filter GX 340 - 390	\$ 27.00



Air Cleaner Assembly

Part No.	Product Details	Each
50.5167	Air Cleaner Assembly GX 120 - 160 - 200	\$ 18.50
50.5168	Air Cleaner Assembly GX 240 - 270	\$ 47.50
50.5169	Air Cleaner Assembly GX 340 - 390	\$ 50.25





(10 Pack) Cover Nut GX Series

Part No.	Product Details	Each
50.5170	(10 Pack) Cover Nut GX Series	\$10.50



Throttle Control Assembly

Part No.	Product Details	Each
50.5196	Throttle Control Assembly GX 140 - 160 - 200	\$ 9.25
50.5197	Throttle Control Assembly GX 240 - 270	\$17.25
50.5198	Throttle Control Assembly GX 340 - 390	\$ 20.00



Muffler Assembly

Part No.	Product Details	Each
50.5224	Muffler Assembly w/ Elbow GX 120 - 160 - 200	\$ 30.50
50.5225	Muffler Assembly GX 240 - 270	\$ 68.50
50.5226	Muffler Assembly GX 340 - 390	\$ 76.25



Muffler Exhaust Pipe

Part No.	Product Details	Each
50.5252	Muffler Exhaust Pipe GX 240- 270 - 340 - 390	\$18.50



(6 Pack) Muffler Gasket Fits

Part No.	Product Details	Each
50.5253	(6 Pack) Muffler Gasket Fits GX 120 - 160 - 200	\$ 3.25
50.5254	(6 Pack) Muffler Gasket Fits GX 240 - 270 - 340 -390	\$ 6.00



Muffler Protector

Part No.	Product Details	Each
50.5255	Muffler Protector GX 390	\$ 30.75

White Fuel Tank Assembly

Part No.	Product Details	Each
50.5280	White Fuel Tank Assembly GX 140 - 160 - 200	\$ 54.50
50.5281	White Fuel Tank Assembly GX 240 - 270 - 340 - 390	\$ 77.00



Black Fuel Tank Assembly

Part No.	Product Details	Each
50.9147	Black Fuel Tank Assembly GX 140 - 160 - 200	\$ 62.00
50.9148	Black Fuel Tank Assembly GX 240 - 270 - 340 - 390	\$ 82.50

Plastic Fuel Tank Cap

Part No.	Product Details	Each
50.5307	Plastic Fuel Tank Cap GX Series w/ Gasket	\$ 6.00



Chrome Fuel Tank Cap

Part No.	Product Details	Each
50.5308	Chrome Fuel Tank Cap GX Series w/ Gasket	\$ 10.75



Fuel Tank Outlet Valve

Part No.	Product Details	Each
50.5309	Fuel Tank Outlet Valve Assembly GX Series	\$ 8.00



(6 Pack) Fuel Tank Joint

Part No.	Product Details	Each
50.5310	(6 Pack) Fuel Tank Joint GX Series	\$ 29.50



Ignition Coil Assembly

Part No.	Product Details	Each
50.5336	Ignition Coil Assembly GX 120 - 160 - 200	\$ 21.25
50.5337	Ignition Coil Assembly GX 240 - 270 - 340	\$ 23.25
50.5338	Ignition Coil Assembly GX 390	\$ 23.25



On/Off Switch Assembly

Part No.	Product Details	Each
50.5340	On/Off Switch Assembly	\$ 3.75





Cylinder Head Assembly

Part No.	Product Details	Each
50.5368	Complete Cylinder Head Assembly GX 160	\$ 102.00
50.5369	Complete Cylinder Head Assembly GX 200	\$ 102.50
50.5370	Complete Cylinder Head Assembly GX 240	\$ 176.75
50.5371	Complete Cylinder Head Assembly GX 270	\$ 172.75
50.5372	Complete Cylinder Head Assembly GX 340	\$ 198.00
50.5373	Complete Cylinder Head Assembly GX 390	\$ 191.25

Spark Plug

Part No.	Product Details	Each
50.5339	Spark Plug GX Series	\$10.50
50.5342	NGK Spark Plug	\$11.25



(6 Pack) GX Spark Plug Noise Suppression Cap

Part No.	Product Details	Each
50.5341	(6 Pack) GX Spark Plug Noise Suppression Cap	\$ 34.75



Rocker Arm Assembly

Part No.	Product Details	Each
50.5411	Rocker Arm Assembly GX 120 - 160 - 200	\$ 4.50
50.5412	Rocker Arm Assembly GX 240 - 270 - 340 - 390	\$ 5.00



Valve Intake/Exhaust Set

Part No.	Product Details	Each
50.5408	Valve Intake/Exhaust Set GX 160 - 200	\$ 12.75
50.5409	Valve Intake/Exhaust Set GX 240 - 270	\$ 25.00
50.5410	Valve Intake/Exhaust Set GX 340 - 390	\$ 27.00



Retainer Intake/Exhaust Set

Part No.	Product Details	Each
50.5413	Retainer Intake/Exhaust Set GX 120 - 160 - 200	\$ 2.25
50.5414	Retainer Intake/Exhaust Set GX 240 - 270 - 340 - 390	\$ 4.75



Valve Lifter Set

Part No.	Product Details	Each
50.5415	Valve Lifter Set GX 120 - 160	\$ 4.50
50.5416	Valve Lifter Set GX 200	\$ 2.50
50.5417	Valve Lifter Set GX 240 - 270 - 340 - 390	\$ 7.75



Control Spring Set

Part No.	Product Details	Each
50.5441	Control Spring Set GX 160 - 200	\$ 3.25
50.5442	Control Spring Set GX 240 - 270	\$ 4.00
50.5443	Control Spring Set GX 390	\$ 4.75



Head Cover

Part No.	Product Details	Each
50.5405	Head Cover GX 120 - 160 - 200	\$ 13.75
50.5406	Head Cover GX 240 - 270	\$ 12.00
50.5407	Head Cover GX 340 - 390	\$ 13.50

(6 Pack) Head Gasket

Part No.	Product Details	Each
50.5399	(6 Pack) Head Gasket GX 160	\$ 19.25
50.5400	(6 Pack) Head Gasket GX 200	\$ 35.00
50.5401	(6 Pack) Head Gasket GX 240	\$ 31.25
50.5402	(6 Pack) Head Gasket GX 270	\$ 32.50
50.5403	(6 Pack) Head Gasket GX 340	\$ 33.50
50.5404	(6 Pack) Head Gasket GX 390	\$ 32.25



(Set of 7) Gasket Kit

Part No.	Product Details	Each
50.5446	(Set of 7) Gasket Kit GX 160	\$ 7.75
50.5447	(Set of 7) Gasket Kit GX 200	\$ 12.00
50.5448	(Set of 7) Gasket Kit GX 240	\$ 13.50
50.5449	(Set of 7) Gasket Kit GX 270	\$ 14.50
50.5450	(Set of 7) Gasket Kit GX 340	\$ 14.75
50.5451	(Set of 7) Gasket Kit GX 390	\$ 14.50



Electric Motor Starter Assembly

Part No.	Product Details	Each
50.5444	Electric Motor Starter Assembly GX 240 - 270	\$ 150.50
50.5445	Electric Motor Starter Assembly GX 340 - 390	\$ 158.25



PRESSURE WASHING & PUMP PARTS TERMS AND CONDITIONS

Terms and Conditions of Sales Order / Confirmation ("Agreement")

- 1. Payment.** Standard terms are net 30 days from date of invoice for accounts with approved credit by VELOCI PERFORMANCETM PRODUCTS ("VELOCI"). A service charge of 1.5% per month may be assessed on invoiced over 30 days.
- 2. Shipping.** All freight is shipped freight collect. All other orders are shipped by United Parcel Service (UPS) unless otherwise specified. UPS charges are prepaid and added to the invoice. All shipping discrepancies must be submitted within 24 hours of receipt of products.
- 3. Pricing.** Veloci Performance Products reserves the right to change discounts and/or prices without notice. Trade discounts are based upon unit and dollar volume and are inclusive of warranty allowance. A surcharge may be added to individual orders in response to foreign currency exchange rate fluctuations. Pricing details include: (a) Price list effective January 1, 2018 - Subject to change without notice; (b) All prices F.O.B. Savage, Minnesota; (c) The price in effect at time of shipment will apply; and (d) Pricing discrepancies must be filed within 30 days of invoice
- 4. Minimum Order.** \$30.01 minimum required for all orders. A \$3.50 minimum order fee may be applied to orders below \$30.01.
- 5. Returns.** Returns must follow the following procedures: (a) Returns for credit must be received within 30 days of shipment and pre-approved by Veloci; (b) All returns must be sent freight paid; (c) A return authorization number and invoice copy must accompany all returns; and (d) Please note that a restocking charge may be assessed.
- 6. LIMITED WARRANTY: VELOCI WARRANTS TO THE ORIGINAL PURCHASER OF ITS PRODUCTS ("PURCHASER") THAT SUCH PRODUCTS WILL BE FREE FROM MATERIAL AND WORKMANSHIP DEFECTS UNDER NORMAL USE FOR THE PERIOD OF NINETY (90) DAYS FOR ALL PRODUCTS. "NORMAL USE" DOES NOT INCLUDE USE IN EXCESS OF RECOMMENDED MAXIMUM SPEEDS, FLOWS, PRESSURES, VACUUMS AND TEMPERATURES, OR USE REQUIRING HANDLING OF FLUIDS NOT COMPATIBLE WITH COMPONENT MATERIALS AS NOTED IN THE VELOCI CATALOG, TECHNICAL LITERATURE, AND INSTRUCTIONS. THIS WARRANTY DOES NOT COVER FREIGHT DAMAGE, FREEZING DAMAGE, NORMAL WEAR AND TEAR, OR DAMAGE CAUSED BY MISAPPLICATION, FAULT, NEGLIGENCE, ALTERATIONS, OR REPAIR THAT AFFECTS THE PERFORMANCE OR RELIABILITY OF THE PRODUCT.**
- 7. DISCLAIMER: EXCEPT FOR THE WARRANTY SET FORTH ABOVE, VELOCI MAKES NO WARRANTY WHATSOEVER WITH RESPECT TO THE PRODUCT, INCLUDING ANY WARRANTY OF MERCHANTABILITY OR WARRANTY OF FITNESS FOR A PARTICULAR PURPOSE; WHETHER EXPRESS OR IMPLIED BY LAW, COURSE OF DEALING, COURSE OF PERFORMANCE, USAGE OF TRADE OR OTHERWISE.**
- 8. EXCLUSIVE REMEDY: PURCHASER'S SOLE AND EXCLUSIVE REMEDY AND VELOCI'S ENTIRE LIABILITY FOR ANY BREACH OF THE LIMITED WARRANTY SET FORTH ABOVE SHALL BE TO REPAIR OR REPLACE SUCH DEFECTIVE PRODUCT. ANY DEFECTIVE PRODUCT MUST BE RETURNED TO VELOCI IN ACCORDANCE WITH THE PROCEDURES SET FORTH UNDER "RETURNS".**
- 9. LIMITATION OF LIABILITY: IN NO EVENT SHALL VELOCI BE LIABLE FOR ANY CONSEQUENTIAL, INDIRECT, INCIDENTAL, SPECIAL, EXEMPLARY, PUNITIVE, OR ENHANCED DAMAGES, LOST PROFITS OR REVENUES OR DIMINUTION IN VALUE, ARISING OUT OF, OR RELATING TO, AND/OR IN CONNECTION WITH ANY BREACH OF THIS AGREEMENT, REGARDLESS OF (A) WHETHER SUCH DAMAGES WERE FORESEEABLE, (B) WHETHER OR NOT VELOCI WAS ADVISED OF THE POSSIBILITY OF SUCH DAMAGES, (C) THE LEGAL OR EQUITABLE THEORY (CONTRACT, TORT OR OTHERWISE) UPON WHICH THE CLAIM IS BASED, AND (D) THE FAILURE OF ANY AGREED OR OTHER REMEDY OF ITS ESSENTIAL PURPOSE. FOR THE PURPOSE OF THIS SECTION "CONSEQUENTIAL DAMAGE" SHALL INCLUDE, BUT NOT BE LIMITED TO, LOSS AND/OR DEFERRAL OF PRODUCTION, LOSS OF PRODUCT, LOSS OF USE, LOSS OF REVENUE, PROFIT OR ANTICIPATED PROFIT, LOSS OF CONTRACT AND/OR BUSINESS OPPORTUNITY. IN NO EVENT SHALL VELOCI'S AGGREGATE LIABILITY ARISING OUT OF OR RELATED TO THIS AGREEMENT, WHETHER ARISING OUT OF OR RELATED TO BREACH OF CONTRACT, TORT (INCLUDING NEGLIGENCE) OR OTHERWISE, EXCEED THE TOTAL OF THE AMOUNTS PAID TO VELOCI FOR THE PRODUCT SOLD HEREUNDER.**
- 10. Indemnification.** Purchaser shall indemnify, defend and hold harmless VELOCI and its officers, directors, employees, agents, affiliates, successors and permitted assigns (collectively, "Indemnified Party") against any and all losses, damages, liabilities, deficiencies, claims, actions, judgments, settlements, interest, awards, penalties, fines, costs, or expenses of whatever kind, including reasonable attorneys' fees, fees and the costs of enforcing any right to indemnification under this Agreement and the cost of pursuing any insurance providers, incurred by Indemnified Party, relating to/arising out of or resulting from any claim of a third party or VELOCI arising out of or occurring in connection with the products sold pursuant to this Agreement or Purchaser's negligence, willful misconduct or breach of this Agreement. Purchaser shall not enter into any settlement without VELOCI's or Indemnified Party's prior written consent.
- 11. Choice of Law/Forum.** This Agreement and all matters arising out of or relating to this Agreement, are governed by, and construed and enforced in accordance with, the laws of the State of Minnesota, without regard to the conflict of interest laws provisions. Each party irrevocably and unconditionally agrees that it will not commence any action, litigation, or proceeding of any kind whatsoever against any other party in any way arising from or relating to this Agreement and all contemplated transactions, including, but not limited to, contract, equity, tort, fraud, and statutory claims, in any forum other than the competent courts in the State of Minnesota.



PUMP KITS

THESE NEWLY OFFERED REPLACEMENT PUMP KITS FIT THE MOST POPULAR MODELS OF PUMP IN THE PRESSURE WASHING INDUSTRY. COMPLETE YOUR SERVICE AND REPAIR OFFERING WITH VELOCI'S ITALIAN MADE REPLACEMENT PUMP KITS.

Veloci Spare Parts for Pumps

Fitting Interpump/General Pump

Pump	Valves	Piston Oil Seal	Packing Seals	Packing w/ Brass	Pistons	Valve Caps	Piston Bolts	Crank Seal
CW1012	Kit 62	Kit 37	Kit 113					Kit 32
CW2004	Kit 1	Kit 2			47040409	Kit 4	Kit 6	Kit 3
CW2040	Kit 1	Kit 2			47040409	Kit 4	Kit 6	Kit 3
CW3040	Kit 1	Kit 2			47040409	Kit 4	Kit 6	Kit 3
CW1541		Kit 44					Kit 74	Kit 32
EZ2536E	Kit 123	Kit 23	Kit 127	Kit 131	44040109	Kit 124		
EZ2542E	Kit 123	Kit 23	Kit 127	Kit 131	44040109	Kit 124		
EZ2545E	Kit 123	Kit 23	Kit 88	Kit 130	52040009	Kit 124		
EZ3035G	Kit 123	Kit 23	Kit 88	Kit 130	52040009	Kit 124		
EZ3040G	Kit 123	Kit 23	Kit 88	Kit 130	52040009	Kit 124		
EZ4040G	Kit 123	Kit 23				Kit 124		
HTS2215S	Kit 201	Kit 2			47040509	Kit 5	Kit 6	
HTX1810S	Kit 123	Kit 159			44040109			
HTX1812S	Kit 123	Kit 159			44040109			
HTX1813S	Kit 123	Kit 159			44040109			
T41	Kit 62	Kit 37					Kit 74	Kit 32
T61	Kit 1	Kit 44		Kit 80			Kit 74	Kit 32
T81	Kit 1	Kit 44		Kit 80			Kit 74	Kit 32
T1011	Kit 1	Kit 2	Kit 8 or 69	Kit 28	47040409	Kit 4	Kit 6	Kit 3
T1321	Kit 1	Kit 2	Kit 148	Kit 29	47040509	Kit 4	Kit 6	Kit 3
TT1505EBF	Kit 1	Kit 83	Kit 141	Kit 140				
T1551	Kit 1	Kit 44	Kit 113					Kit 32
T1621	Kit 1	Kit 2	Kit 148	Kit 29	47040509	Kit 4	Kit 6	Kit 3
T2031	Kit 1	Kit 24	Kit 69	Kit 28		Kit 4	Kit 6	
T4251	Kit 122	Kit 44	Kit 77					Kit 32
T5050	Kit 1	Kit 2						Kit 3
T9051EBF	Kit 1	Kit 83	Kit 97	Kit 96				
T921	Kit 1	Kit 2	Kit 148	Kit 29	47040509	Kit 4	Kit 6	Kit 3
T9211	Kit 1	Kit 2	Kit 8 or 69	Kit 28	47040409	Kit 5	Kit 6	Kit 3
T9281	Kit 1	Kit 2						Kit 3
T9721	Kit 1	Kit 23	Kit 19	Kit 27	50040409	Kit 4	Kit 6	
T9731	Kit 1	Kit 23	Kit 19	Kit 27	50040409	Kit 4	Kit 6	
T9791	Kit 1	Kit 23	Kit 19	Kit 27	50040409	Kit 4	Kit 6	

Veloci Spare Parts for Pumps

Fitting Interpump/General Pump

Pump	Valves	Piston Oil Seal	Packing Seals	Packing w/ Brass	Pistons	Valve Caps	Piston Bolts	Crank Seal
T991	Kit 1	Kit 23	Kit 19	Kit 27	50040409	Kit 4	Kit 6	
T9951	Kit 1	Kit 23	Kit 19	Kit 27	50040409	Kit 4	Kit 6	
T9971	Kit 1	Kit 23	Kit 19	Kit 27	50040409	Kit 4	Kit 6	
TC1507E345	Kit 123	Kit 83						
TP2530J34	Kit 123	Kit 83	Kit 97	Kit 96	51040009			
TS1011	Kit 1	Kit 2	Kit 8 or 69	Kit 28	47040409	Kit 4	Kit 6	Kit 3
TS1021	Kit 1	Kit 2	Kit 8 or 69	Kit 28	47040409	Kit 4	Kit 6	Kit 3
TS1041	Kit 62	Kit 37	Kit 8 or 69		47040409			Kit 32
TS1321	Kit 1	Kit 2	Kit 148	Kit 29	47040509	Kit 4	Kit 6	Kit 3
TSS1511	Kit 1	Kit 2	Kit 8 or 69	Kit 28	47040409		Kit 6	Kit 3
TS1531	Kit 62	Kit 37	Kit 8 or 69		47040409			Kit 3
TS1621	Kit 1	Kit 2	Kit 148	Kit 29	47040509	Kit 5	Kit 6	Kit 3
TS1711	Kit 1	Kit 2	Kit 8 or 69	Kit 28	47040509	Kit 4	Kit 6	Kit 3
TS1811	Kit 1	Kit 2	Kit 8 or 69	Kit 28	47040509	Kit 4	Kit 6	Kit 3
TS2011	Kit 1	Kit 2	Kit 8 or 69	Kit 28	47040509	Kit 4	Kit 6	Kit 3
TS2021	Kit 1	Kit 2	Kit 8 or 69	Kit 28	47040509	Kit 4	Kit 6	Kit 3
TSF2019	Kit 169	Kit 2	Kit 170	Kit 171	66040009			Kit 3
TSF2021	Kit 169	Kit 2	Kit 170	Kit 171	66040009			Kit 3
TSF2219	Kit 169	Kit 2						Kit 3
TSF2221	Kit 169	Kit 2						Kit 3
TSP1819		Kit 2						Kit 3
TT2028	Kit 1	Kit 83	Kit 97	Kit 96	51040009			
TT2035	Kit 1	Kit 83	Kit 97	Kit 96	51040009			
TT9061	Kit 1	Kit 83	Kit 97	Kit 96	51040009			
TT9071	Kit 1	Kit 83	Kit 97	Kit 96	51040009			
TT9111	Kit 1	Kit 83	Kit 141	Kit 140				
TT9351	Kit 1	Kit 23	Kit 88	Kit 92	52040009	Kit 4	Kit 6	
TT941	Kit 1	Kit 83	Kit 97	Kit 96	51040009			
TT9441	Kit 1	Kit 23	Kit 88	Kit 92	52040009	Kit 4	Kit 6	
TX1508G8	Kit 123	Kit 159	Kit 160	Kit 166	52040009	Kit 124		
TX1510G8	Kit 123	Kit 159	Kit 160	Kit 166	52040009	Kit 124		
TX1510S34	Kit 123	Kit 159	Kit 160	Kit 166	52040009	Kit 124		
TX1512S17	Kit 123	Kit 159	Kit 160	Kit 166	52040009	Kit 124		
TX1812S17	Kit 123	Kit 159	Kit 161	Kit 167	44040109	Kit 124		

Veloci Spare Parts for Pumps

Fitting Interpump/General Pump

*** Use Veloci No. when ordering ***

Veloci No.	Kit No.	Description	List Price
49.6001	Kit 1	CHECK VALVES+ O-RINGS	\$62.00
49.6002	Kit 2	PISTON OIL SEAL Ø22X32X5,5 (1X3 PCS)	\$22.75
49.6003	Kit 3	SHAFT OIL SEAL Ø30X55X7 (1X2 PCS)	\$22.75
49.6004	Kit 4	BRASS CAPS +O.R. (2X6 PCS)	\$110.30
49.6005	Kit 5	NICKELED BRASS CAPS + O.R. (2X6 PCS)	\$151.00
49.6006	Kit 6	PISTON BOLTS(5X3 PCS)	\$50.50
49.6007	Kit 7	HEAD RINGS Ø20 (1X6 PCS)	\$17.00
49.6008	Kit 8 Old	OLD H.P. SEALS Ø20X35 (1X6 PCS)	\$67.50
49.6009	Kit 8	HIGH/LOW PRESSURE SEALS Ø20 (2X3 PCS)	\$67.50
49.6010	Kit 9	INTERMED RING+LONG LIFE Ø20 (2X3 PCS)	\$88.00
49.6011	Kit 10	NEW PACKINGRETAINERS+OR Ø20 (2X3PCS)	\$62.00
49.6012	Kit 11	HEAD RINGS Ø22 (1X6 PCS)	\$15.00
49.6013	Kit 12	HIGH/LOW PRESSURE SEALS Ø22 (2X3PCS)	\$81.40
49.6014	Kit 14	PACKING RETAINERS+O.R. Ø22 (2X3 PCS)	\$44.75
49.6015	Kit 19 Old	OLD H.P. SEALS Ø20X30 (1X6 PCS)	\$103.00
49.6016	Kit 19	HIGH/LOW PRESSURE SEALS Ø20 (2X3PCS)	\$62.20
49.6017	Kit 20	INTERMEDIATE RING Ø20 (1X3 PCS)	\$48.75
49.6018	Kit 21	HEAD RINGS Ø20 (1X6 PCS)	\$15.00
49.6019	Kit 22	PACKING RETAINERS+O.R. Ø20 (2X3 PCS)	\$40.75
49.6020	Kit 23	PISTON OIL SEAL Ø20X30X5 (1X3PCS)	\$27.00
49.6021	Kit 24	PISTON OIL SEAL Ø22X35X8 (1X3PCS)	\$30.00
49.6022	Kit 27	COMPLETE SEAL PACKING Ø20 (6X1 PCS)	\$48.00
49.6023	Kit 28	COMPLETE SEAL PACKING Ø20(7X1PCS)	\$62.00
49.6024	Kit 29	COMPLETE SEAL PACKING Ø22 (7X1 PCS)	\$62.00
49.6025	Kit 32	SHAFT OIL SEAL Ø35X52X8 (1X2 PCS)	\$18.00
49.6026	Kit 37	PISTON OIL SEALS Ø32X42X7 (1X3 PCS)	\$20.00
49.6027	Kit 44	PISTON OIL SEALS Ø35X52X7 (1X3 PCS)	\$20.00
49.6028	Kit 62	VALVES + O.R. (2X6 PCS)	\$377.00
49.6029	Kit 65	HEAD RINGS Ø30 (1X6 PCS)	\$47.25
49.6030	Kit 66	INTERMEDIATERING Ø30 (1X3 PCS)	\$290.00
49.6031	Kit 69	SEAL PACKINGØ20 (3X3 PCS)	\$99.00
49.6032	Kit 71	INTERMED. RINGS+RESTOP Ø20 (2X3 PCS)	\$106.00
49.6033	Kit 77	SEAL PACKINGØ20 (3X3 PCS)	\$99.50
49.6034	Kit 80	COMPLETE SEAL PACKING Ø45 (7X1 PCS)	\$296.50
49.6035	Kit 83	PISTON OIL SEAL Ø15X24X5 (1X3 PCS)	\$18.25
49.6036	Kit 85	COMPLETE SEAL PACKING Ø15 (5X1 PCS)	\$27.00
49.6037	Kit 86	PACKING RETAINERS+O.R. Ø15 (3X3 PCS)	\$42.50
49.6038	Kit 87	SEAL PACKINGØ15 (4X3 PCS)	\$60.25

Veloci No.	Kit No.	Description	List Price
49.6039	Kit 88	SEAL PACKINGØ15 (3X3 PCS)	\$71.75
49.6040	Kit 89	INTERMEDIATERINGS Ø15 (1X3 PCS)	\$85.00
49.6041	Kit 90	HEAD RINGS Ø15 (1X6 PCS)	\$14.75
49.6042	Kit 91	PACKING RETAINERS+O.R. Ø15 (2X3 PCS)	\$116.50
49.6043	Kit 92	COMPLETE SEAL PACKING Ø15 (7X1 PCS)	\$112.00
49.6044	Kit 96	COMPLETE SEAL PACKING Ø15 (5X1 PCS)	\$22.75
49.6045	Kit 97	SEAL PACKINGØ15 (4X3 PCS)	\$32.70
49.6046	Kit 113	SEAL PACKINGØ30 (3X3 PCS)	\$166.00
49.6047	Kit 122	VALVES + O.R. (2X6 PCS)	\$1,025.00
49.6048	Kit 123	NEW VALVES+ O-R. (2X6 PCS)	\$81.40
49.6049	Kit 124	BRASS CAPS+ O.R. (2X6 PCS)	\$175.50
49.6050	Kit 125	PACKING RETAINERS+OR Ø15 (2X3 PCS)	\$65.00
49.6051	Kit 127	SEAL PACKING Ø18 (3X3 PCS)	\$97.00
49.6052	Kit 129	HEAD RINGSØ18 (1X6 PCS)	\$11.60
49.6053	Kit 130	COMPLETE SEAL PACKING Ø15 (7X1 PCS)	\$64.30
49.6054	Kit 131	COMPLETE SEAL PACKING Ø18 (7X1 PCS)	\$79.10
49.6055	Kit 134	VALVES + O.R. (2X6 PCS)	\$86.00
49.6056	Kit 140	COMPLETE SEAL PACKING Ø18 (5X1 PCS)	\$33.25
49.6057	Kit 141	SEAL PACKINGØ18 (4X3 PCS)	\$48.50
49.6058	Kit 148	SEAL PACKING Ø22 (3X3 PCS)	\$113.00
49.6059	Kit 159	PISTON OILSEAL Ø18X26X6 (1X3PCS)	\$15.00
49.6060	Kit 160	SEAL PACKING Ø15 (4X3 PCS)	\$121.20
49.6061	Kit 161	SEAL PACKING Ø18 (4X3 PCS)	\$121.40
49.6062	Kit 162	PACKING RETAINERS Ø15 (1X3 PCS)	\$45.00
49.6063	Kit 166	COMPLETE SEAL PACKING Ø15 (7X1 PCS)	\$76.75
49.6064	Kit 167	COMPLETE SEAL PACKING Ø18 (7X1 PCS)	\$76.75
49.6169	Kit 169	CHECK VALVES (2X3)	\$241.40
49.6170	Kit 170	SEAL PACKING KIT (20MM)	\$127.50
49.6171	Kit 171	COMPLETE SEAL PACKING KIT (20MM)	\$105.80
49.6065	Kit 201	VALVES +O-R. (3X6 PCS)	\$227.50
49.6069	44040109	CERAMIC PISTON Ø18X37,5 (1 PC)	\$63.75
49.6067	47040409	CERAMIC PISTON Ø20X50 (1 PC)	\$65.00
49.6070	47040509	CERAMIC PISTON Ø22X50 (1 PC)	\$67.50
49.6066	50040409	CERAMIC PISTON Ø20X40 (1 PC)	\$71.00
49.6168	51040009	CERAMIC PLUNGER 15 X 25	\$48.90
49.6068	52040009	CERAMIC PISTON Ø15X37,5 (1 PC)	\$62.50
49.6172	66040009	CERAMIC PLUNGER I20 (20MM)	\$102.00
49.6166	47 Series	BRASS PUMP HEAD	\$822.40
49.6167	47 series	NICKEL PLATED BRASS PUMP HEAD	\$955.40
49.6173	Kit 10	(50 Pack) O-RINGS FOR GP 47-48 SERIES	\$14.30
49.6174	Kit 1 & 123	(50 Pack) O-RINGS FOR GP PUMP VALVES	\$10.20
49.6175	Kit 4 & 5	(50 Pack) O-RINGS FOR GP PUMP CAPS	\$11.70

Veloci Spare Parts for Pumps

Fitting Annovi Reverberi Pumps

Pump Style	Size	Check Valves	Water Seals	Oil Seals	Pistons
RK	18mm	Kit 2864	Kit 1857	Kit 1855	Kit 2546 / 2757
	20mm	Kit 2864	Kit 1887	Kit 1855	Kit 2547
	22mm	Kit 2864	Kit 1888	Kit 1855	Kit 2759
RKA	18mm	Kit 2864	Kit 1857	Kit 1856 - E version	
	20mm	Kit 2864	Kit 1887	Kit 1855 - N version	
	22mm	Kit 2864	Kit 1888		Kit 2759
RKV		Kit 1828	Kit 1857	Kit 1856 - E version	
RRV		Kit 1828			
RSV	15mm				Kit 2187
SXMV	15mm	Kit 2125	Kit 2741	Kit 2787	
SXW	18mm	Kit 2871			
XM	15mm	Kit 1864	Kit 2741	Kit 2786	
	18mm	Kit 1864		Kit 2786	Kit 2747
XMA	15mm	Kit 1864	Kit 2741	Kit 2787 Hollow	
	18mm	Kit 1864	Kit 2747	Kit 2786 Solid	
XMV	15mm	Kit 1864	Kit 2741	Kit 2787	
XW	20mm	Kit 2780	Kit 2782	Kit 2781	
	22mm	Kit 2780	Kit 2783	Kit 2781	
XW-M	20mm	Kit 2780		Kit 2781	
XWA	20mm	Kit 2780	Kit 2782	Kit 2781	
	22mm	Kit 2780	Kit 2783	Kit 2781	Kit 2783
XWA-M		Kit 2780		Kit 2781	
XTA		Kit 1864	Kit 2520 - 15mm	Kit 1860 - Hollow	Kit 2628 - 15mm
			Kit 1874 - 18mm	Kit 1872 - Solid	Kit 2629 - 18mm

Notes:

Veloci Spare Parts for Pumps

Fitting Annovi Reverberi Pumps

Veloci No.	Kit No.	Description	List Price
49.6071	Kit 1815	HEAD RINGS Ø20 (XR)	\$13.75
49.6072	Kit 1816	HEAD RINGS Ø22 (XR)	\$18.00
49.6073	Kit 1828	VALVES +O-RINGS (2X6 PCS)	\$58.50
49.6074	Kit 1829	HEAD RINGS Ø18 (XR)	\$25.50
49.6075	Kit 1855	OIL SEALS	\$63.00
49.6076	Kit 1856	OIL SEALS(XR)	\$63.50
49.6077	Kit 1857	SEAL PACKING Ø18 (3X3 PCS)	\$108.60
49.6078	Kit 1860	OIL SEALS(XT)	\$46.00
49.6079	Kit 1864	VALVES +O-RINGS (2X6 PCS)	\$49.70
49.6080	Kit 1865	OIL SEALS(HPE)	\$39.25
49.6081	Kit 1866	SEAL PACKING Ø15 (6X3 PCS)	\$81.00
49.6082	Kit 1872	OIL SEALS	\$40.00
49.6083	Kit 1874	SEAL PACKING Ø18 (4X3 PCS)	\$80.50
49.6084	Kit 1887	SEAL PACKING Ø20 (3X3 PCS)	\$118.60
49.6085	Kit 1888	SEAL PACKING Ø22 (XR)	\$141.50
49.6086	Kit 1891	CERAMIC PLUNGERS Ø22X45 (XL)	\$170.00
49.6087	Kit 2040	SET O.R.(BLITZ-HPE)	\$12.00
49.6088	Kit 2125	VALVES +O-RINGS (SXMS) (2X6PCS)	\$48.25
49.6089	Kit 2520	SEAL PACKING Ø15 (6X3 PCS)	\$85.50
49.6090	Kit 2628	CERAMIC PISTON Ø15X30 (1X3 PCS)	\$150.60
49.6091	Kit 2629	CERAMIC PISTON Ø18X30 (1X3 PCS)	\$140.00
49.6092	Kit 2650	CERAMIC PLUNGERS Ø20X45	\$170.00
49.6093	Kit 2739	CERAMIC PLUNGERS Ø15X35 (XM)	\$136.00

*** Use Veloci No. when ordering ***

Veloci No.	Kit No.	Description	List Price
49.6094	Kit 2740	HEAD RINGS Ø15 (XM)	\$9.75
49.6095	Kit 2741	SEAL PACKING Ø15 (3X3 PCS)	\$86.80
49.6096	Kit 2745	HEAD RINGS Ø18 (XM)	\$9.80
49.6097	Kit 2746	CERAMIC PLUNGERS Ø18X35 (XM)	\$160.00
49.6098	Kit 2747	SEAL PACKING Ø18 (3X3 PCS)	\$95.50
49.6099	Kit 2757	CERAMIC PISTON Ø18X40 (1X3 PCS)	\$112.00
49.6100	Kit 2758	CERAMIC PISTON Ø20X40 (1X3 PCS)	\$105.00
49.6101	Kit 2759	CERAMIC PISTON Ø22X40 (1X3 PCS)	\$317.00
49.6102	Kit 2780	VALVES +O-RINGS (XW) (2X6PCS)	\$245.00
49.6103	Kit 2781	OIL SEALS(XW-XWL)	\$58.70
49.6104	Kit 2782	SEAL PACKING Ø20 (XW)(5X3PCS)	\$125.00
49.6105	Kit 2783	SEAL PACKING Ø22X32 (XW)	\$135.00
49.6106	Kit 2784	PLUNGERGUIDE Ø20 (XW)	\$229.00
49.6107	Kit 2785	PLUNGERGUIDE Ø22 (XW)	\$227.00
49.6108	Kit 2786	OIL SEALS	\$39.50
49.6109	Kit 2787	OIL SEALS(XM)	\$56.50
49.6110	Kit 2864	VALVES + O-RINGS (2X6 PCS)	\$64.00
49.6111	Kit 2872	CERAMIC PLUNGERS Ø18X48 (SXW)	\$150.00
49.6112	Kit 42169	VALVES +O-RINGS (RW)	\$54.50
49.6113	Kit 42170	OIL SEALS (RW)	\$52.00
49.6114	Kit 42171	SEAL PACKING Ø18 (RW)	\$81.00
49.6115	Kit 42172	PLUNGERGUIDE (RW)	\$336.00

Veloci Spare Parts for Pumps

Fitting Comet Pumps

*** Use Veloci No. when ordering ***

Veloci No.	Kit No.	Description	List Price
49.6132	0009.0170.00	PISTON BOLTS FW-TW Ø18 (5X3 PCS)	\$40.50
49.6159	0019.0007.00	SHAFT OILSEAL 25X52X7 (1 PC)	\$9.60
49.6154	0019.0032.00	SHAFT OIL SEAL 30X52X7 (1 PC)	\$7.70
49.6158	0019.0034.00	SHAFT OIL SEALS Ø40X55X7	\$10.10
49.6155	0019.0052.00	SHAFT OIL SEAL 40X52X7 (1 PC)	\$8.40
49.6140	0019.0058.00	PISTON OIL SEALS Ø14X22X5/7 (1X3PCS)	\$16.20
49.6138	0019.0066.00	PISTON OIL SEALS 20X30X5 (1X3 PCS)	\$16.00
49.6157	0019.0075.00	SHAFT OIL SEALS Ø35X62X7 (1PC)	\$10.30
49.6136	0019.0081.00	PISTON OIL SEALS 15X24 (1X3 PCS)	\$16.00
49.6156	0019.0094.00	SHAFT OIL SEALS Ø25X62X10/7	\$8.70
49.6137	0019.0095.00	PISTON OIL SEALS 15X24X5 (1X3 PCS)	\$15.00
49.6160	0019.0102.00	SHAFT OILSEAL 40X62X7 (1 PC)	\$11.20
49.6139	0019.0116.00	PISTON OIL SEALS 22X32X7 (1X3 PCS)	\$13.30
49.6142	0019.0128.00	PLUNGER OIL SEALS 20X28X5 FPM	\$31.50
49.6117	0202.0018.00	CERAMIC PISTON Ø18X30 (1 PC)	\$47.80
49.6116	0202.0020.00	CERAMIC PISTON Ø15X30 (1 PC)	\$40.50
49.6118	0202.0022.00	CERAMIC PISTON Ø18X44 (1 PC)	\$54.30
49.6120	0202.0024.00	CERAMIC PISTON Ø20X44 (1 PC)	\$50.20
49.6119	0202.0042.00	CERAMIC PISTON Ø18X52 (1 PC)	\$48.00
49.6121	0202.0043.00	CERAMIC PISTON Ø22X53 (1PC)	\$56.50
49.6131	0600.0054.00	PISTON BOLTS (5X3 PCS)	\$41.80
49.6133	0600.0048.00	PISTON BOLTS LW (5X3 PCS)	\$38.00
49.6134	0600.0062.00	PISTON BOLTS TW Ø22 Ø25(5X3 PCS)	\$53.50
49.6141	2409.0057.00	PLUNGER 15X83 (1 PC)	\$57.80
49.6135	2409.0087.00	PISTON Ø14 W/ STOP RINGS FOR SPRING	\$40.50

Veloci No.	Kit No.	Description	List Price
49.6144	5019.0025.00	SEAL PACKING Ø15 (3X3PCS)	\$41.60
49.6126	5019.0035.00	COMPLETE SEAL PACKING Ø15 (5X1PCS)	\$53.50
49.6145	5019.0035.00	SEAL PACKING Ø15 (4X3 PCS)	\$51.00
49.6127	5019.0037.00	COMPLETE SEAL PACKING Ø18 (5X1PCS)	\$60.80
49.6147	5019.0037.00	SEAL PACKING Ø18 (4X3 PCS)	\$52.70
49.6128	5019.0038.00	COMPLETE SEAL PACKING Ø18 (8X1PCS)	\$109.30
49.6148	5019.0038.00	SEAL PACKING Ø18 (6X3 PCS)	\$104.80
49.6124	5019.0039.00	COMPLETE SEAL PACKING Ø20 (8X1PCS)	\$125.30
49.6150	5019.0039.00	SEAL PACKING Ø20 (6X3 PCS)	\$161.70
49.6122	5019.0064.00	COMPLETE SEAL PACKING Ø15 ZWD-K	\$59.20
49.6146	5019.0064.00	SEAL PACKING Ø15 (5X3 PCS)	\$62.40
49.6125	5019.0077.00	COMPLETE SEAL PACKING Ø14	\$95.00
49.6143	5019.0077.00	SEAL PACKING Ø14	\$52.10
49.6129	5019.0218.00	H.P. SEALS Ø18 FS2 150-15 & 200-15	\$101.80
49.6130	5019.0631.00	H.P. SEALS Ø18	\$142.40
49.6149	5019.0645.00	SEAL PACKING Ø18 TW (6X3 PCS)	\$125.60
49.6152	5019.0646.00	SEAL PACKING Ø22 TW (6X3 PCS)	\$145.10
49.6153	5019.0647.00	SEAL PACKING Ø25 TW (6X3 PCS)	\$157.40
49.6151	5019.0672.00	SEAL PACKING Ø20(5X3PCS)	\$155.70
49.6123	5019.0673.00	COMPLETE SEAL PACKING Ø18(6X3PCS)	\$143.80
49.6161	5025.0011.00	VALVES + O .R. (3X6 PCS)	\$69.70
49.6164	5025.0014.00	VALVES + O-RINGS	\$47.80
49.6165	5025.0020.00	VALVES +O.R. (7X6 STK)	\$145.40
49.6162	5025.0021.00	VALVES + O.R. (8X6 PCS)	\$227.00
49.6163	5025.0025.00	VALVES + OR. (3X6 PCS)	\$169.80

Choose the Power of Compatibility

Our extensive line of aftermarket pump kits is perfectly suited for any service center seeking O.E.M. grade parts with 25% savings. Our valves and seals are perfect for use in car washes and industrial applications offering the highest quality and performance.

Notes:
